



Single Monitor Desk Stand Instruction Manual

(A)

English pages 02–10

French pages 11–19

Spanish pages 20–28

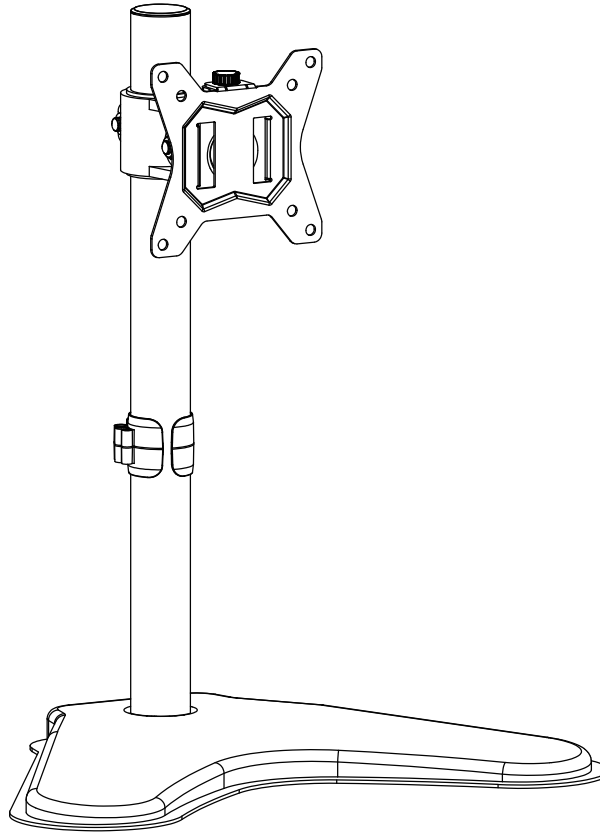

Model: ERDAM1-01B

Thank You for Choosing this ErgoAV Product!

At ErgoAV, we want to add value to your AV experience by providing the highest quality products and services in the industry. If you have any concerns or comments, please contact us.

ErgoAV Customer Care

phone (877) 419-7832

email: support@ergoav.com

website: www.ergoav.com

address: 9501 Louisiana Ave N, #200, Brooklyn Park, MN 55445

IMPORTANT SAFETY INFORMATION

• Please carefully read all instructions before attempting installation. If you do not understand the instructions or have any concerns or questions, please contact Technical Support at (877) 419-7832 or Customer Service at support@ergoav.com.

⚠ CAUTION: Avoid potential personal injuries and property damage!

- Do not use this product for any purpose that is not explicitly specified in this manual. Do not exceed weight capacity. We are not liable for damage or injury caused by improper mounting, incorrect assembly or inappropriate use.
- Do Not use this product on desks made of particle board or other soft woods.
- The information contained in this manual does not cover all possible conditions or variables in relation to the installation of this product.

Weight Restrictions



If your monitor weighs more, this mount is NOT compatible. Monitor should not exceed maximum listed weight.

⚠ WARNING

DO NOT exceed the maximum weight indicated. This mounting system is intended for use only within the weight range listed. Use with products heavier than the maximum weight limit may result in failure of the mount, causing potential damage and or injury.

It is the responsibility of the installer to verify the total weight of the monitors and any accessories attached. Do Not exceed the weight limit listed.

Check the VESA Pattern of Your Monitor before the Installation

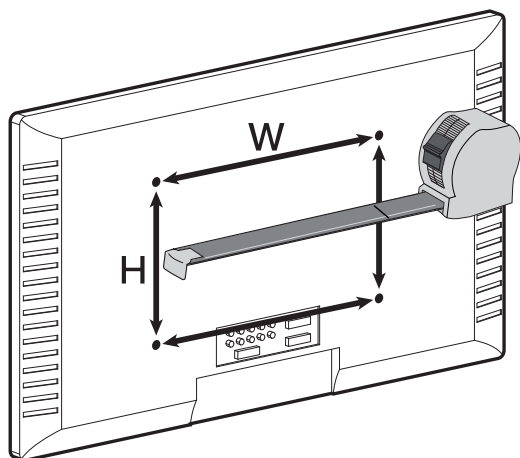

75mm ≈ 3"
100mm ≈ 4"

Measure Your Monitor VESA Pattern:

Minimum: 75mm × 75mm / 3" × 3" (W × H)

Maximum: 100mm × 100mm / 4" × 4" (W × H)

If your Monitor's VESA Pattern is smaller than 75mm x 75mm or greater than 100mm x 100mm, this mount is NOT COMPATIBLE with your Monitor. Please contact our Technical Support at (877) 419-7832 or support@ergoav.com to find a compatible mount.

Tools Needed (Not Included)

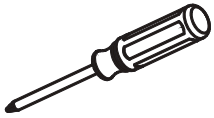

Phillips Screwdriver

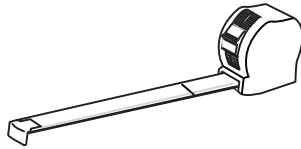

Tape Measure

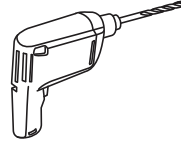

Drill (Optional)



15/32" – 3/4" (12mm – 20mm)
Wood Drill Bit (Optional)

Supplied Parts and Hardware

⚠ WARNING: This product contains small items that could be a choking hazard if swallowed.

Before starting assembly, verify all parts are included and undamaged. Do Not use damaged or defective parts. If you need replacement parts, please contact Tech Support at (877) 419-7832 or Customer Service at support@ergoav.com.

• **NOTE :** Not all hardware included in this package will be used.

Supplied Parts and Hardware for Step 1



Base

01 X 1

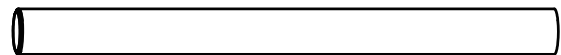

Support Pillar

02 X 1

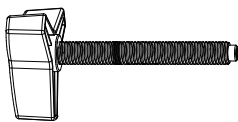

Knob

03 X 1



Grommet Plate

04 X 1



Small Allen key
5/32" (4mm)

05 X 1

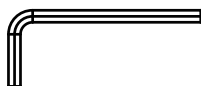

Medium Allen Key
3/16" (5mm)

06 X 1



Bolt

A X 3

Step 1 Install the Support Pillar

Align the holes from the Base [01] with the holes on the Support Pillar [02] and secure them with the three Bolts [A] and the Allen Key [05].

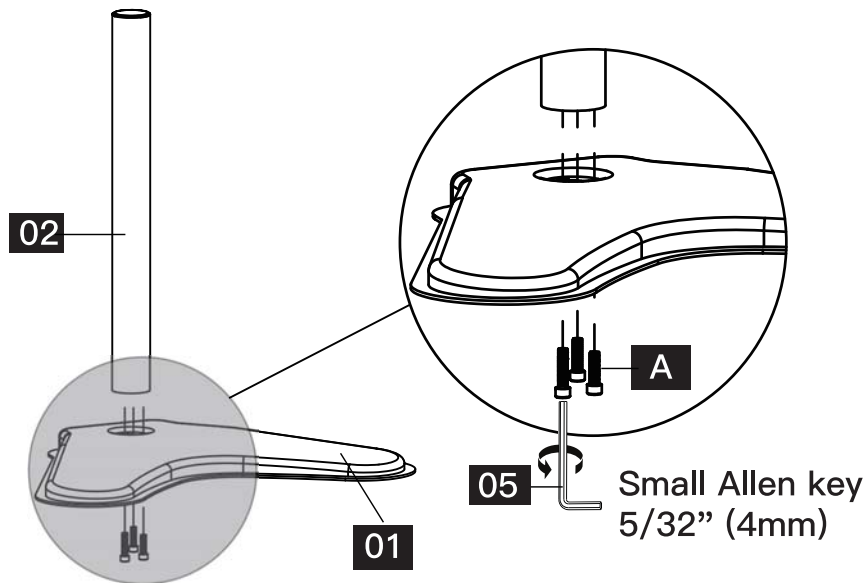

Select the Option According to Your Needs

Option A Free Standing Base

You can proceed to Step 2.

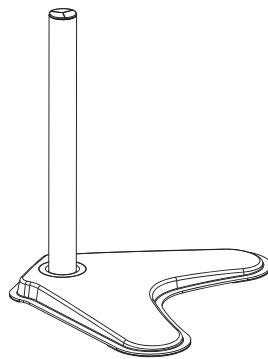

Option B Existing Grommet Hole Installation

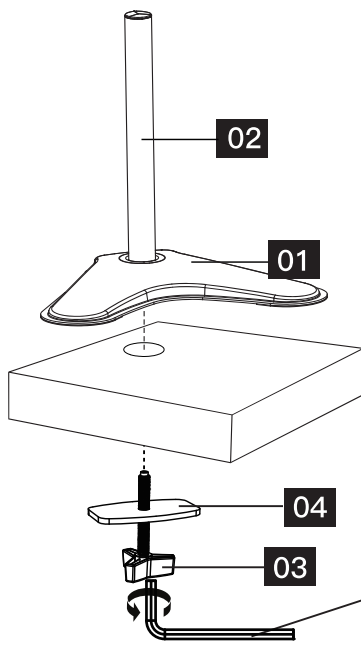

Position the Base Assembly [01] and [02] on the mounting surface and secure using the Grommet Plate [04], Knob [03]. Tighten the Knob [03] using the provided Allen Key [06].

NOTE: If your desk has an existing grommet hole with a plastic cover, remove it before installation.

For Desk Thickness: 3/4" – 1 1/2" (20mm – 40mm)

06 Medium Allen Key
3/16" (5mm)

Option C Self-Drilled Grommet Hole Installation

1. Make a mark for the center hole on your mounting surface. Use a minimum of 15/32" (12mm) and a maximum of 3/4" (20mm) drill bit and drill a hole in the mounting surface.
2. Position the center of the Base Assembly [01] and [02] over the drilled hole in the mounting surface and secure it using the Grommet Plate [04], Knob [03]. Tighten the Knob [03] using the provided Allen Key [06].

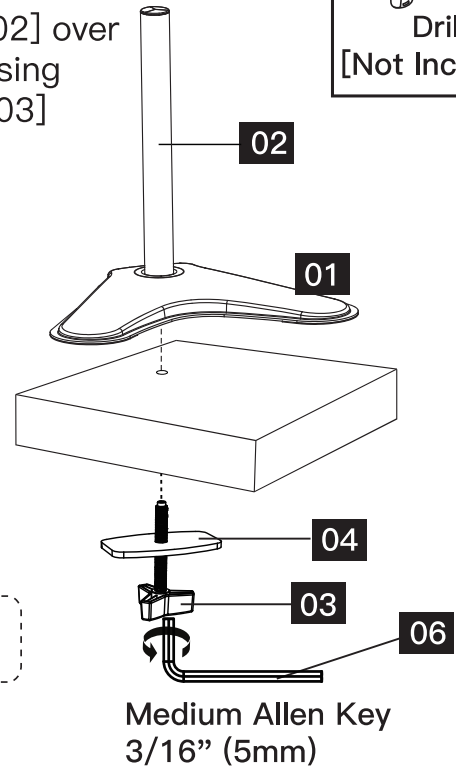
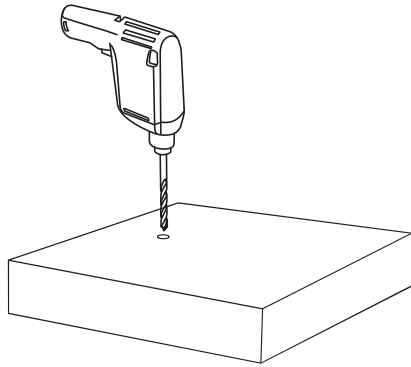

For Desk Thickness: 3/4" – 1 1/2" (20mm – 40mm)

Medium Allen Key
3/16" (5mm)

Supplied Parts and Hardware for Step 2

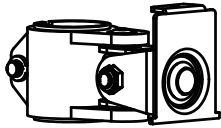

Monitor Connector

07 X 1



Cable Clip

08 X 1



Large Allen Key
15/64" (6mm)

09 X 1

Step 2 Attach the Cable Clip and Monitor Connector to the Support Pillar

Step 2-1

Slide the Cable Clip [08] and Monitor Connector [07] onto the Support Pillar [02].

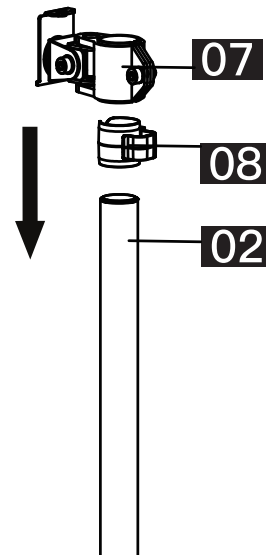

Step 2-2

Secure the Monitor Connector [07] to the Support Pillar [02] using the Allen Key [09] to tighten the Bolt.

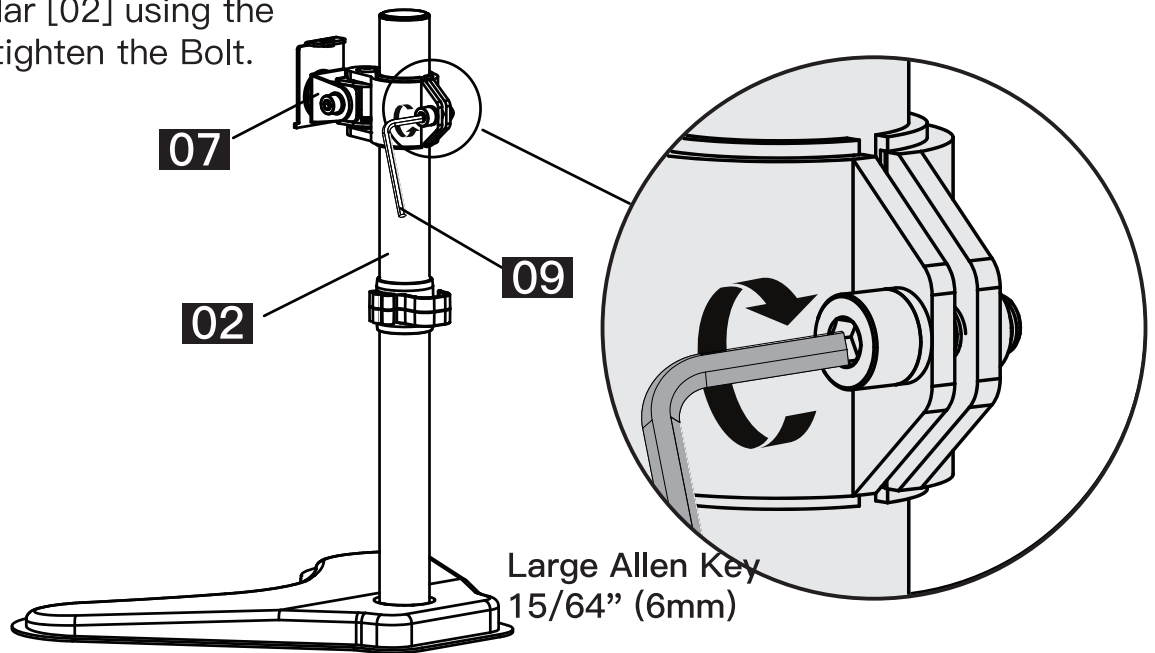

Before starting Step 3, make sure the head of the Monitor Connector [07] is vertical by sliding Monitor Plate [10] on and adjusting until vertical.

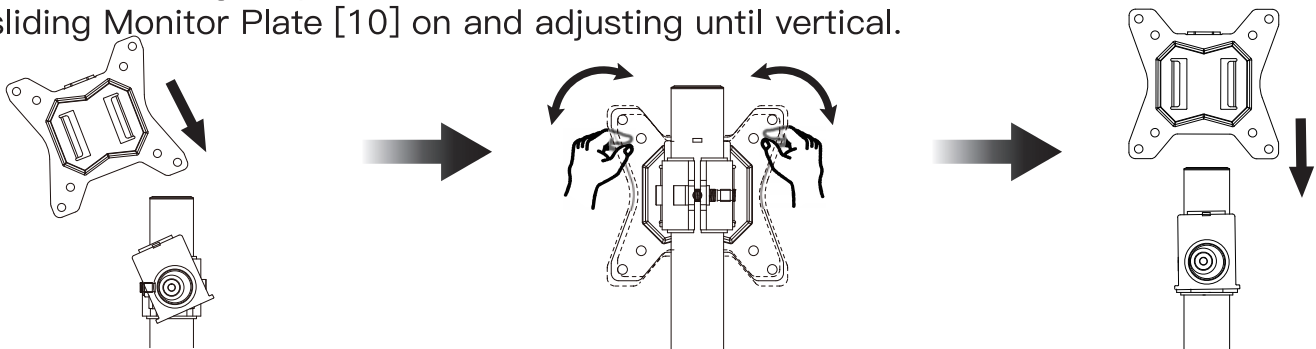

Supplied Parts and Hardware for Step 3

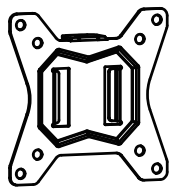

Monitor Plate

10 X 1

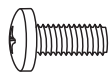

Bolt
M4 x 12mm
B X 4

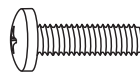

Bolt
M4 x 30mm
C X 4

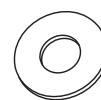

Washer D4
D X 4



13mm Spacer
E X 4

Step 3 Attach the Monitor Plate

Only one size bolt fits your monitor.

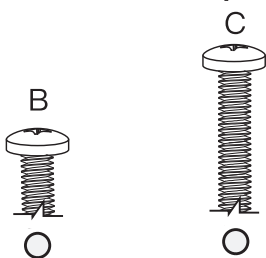

M4 x 12mm

M4 x 30mm

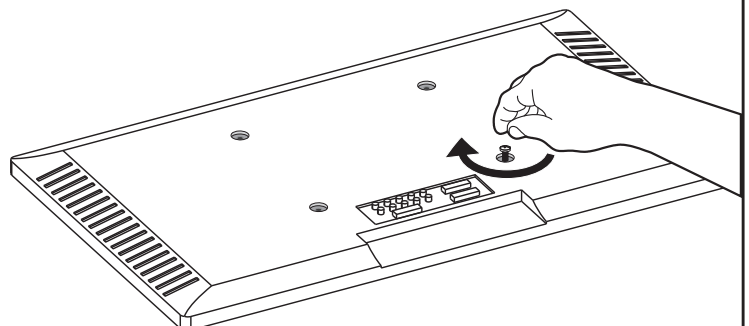

Bolt length: Verify adequate thread engagement with bolts or bolts / spacers combination. We recommend thread engagement of at least 5 turns.

-Too short will not hold the monitor.

-Too long will damage the monitor.

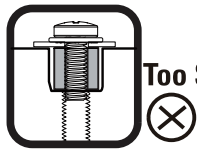

Too Short

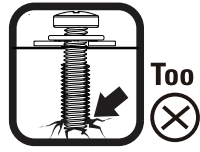

Too Long

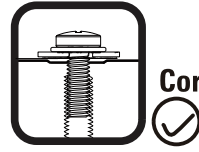

Correct

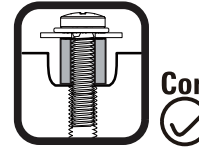

Correct

Option A (For Flat Back Monitor)

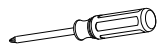
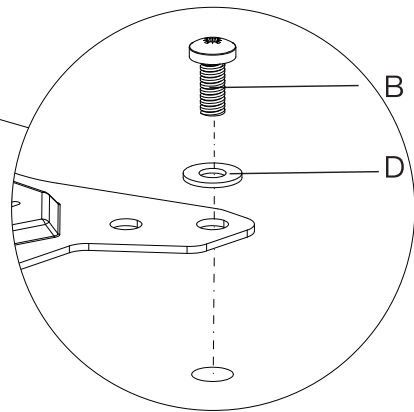
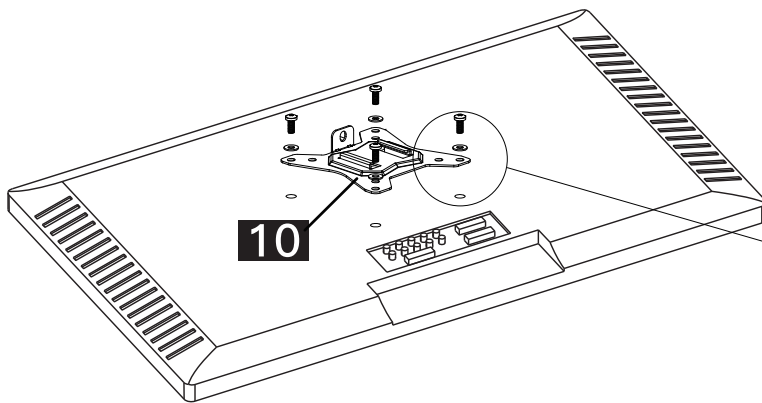

Phillips
Screwdriver
[Not Included]

Option B (For Curved Back Monitor)

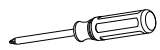
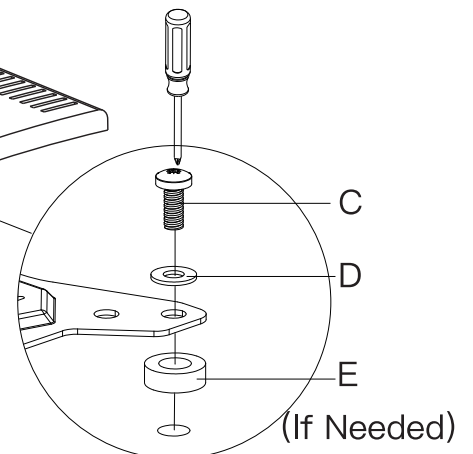
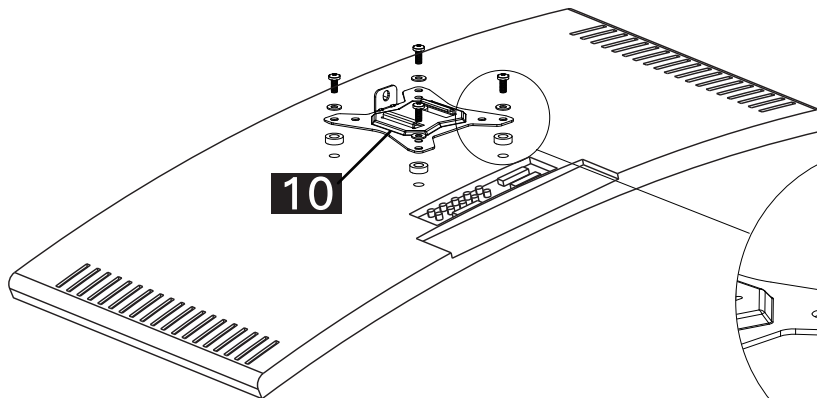

Phillips
Screwdriver
[Not Included]

Supplied Hardware for Step 4



Bolt
F X 1

Step 4 Attach the Monitor to the Stand

Slide the Monitor Plate [10] onto the Monitor Connector [07] and secure with the Bolt [F].

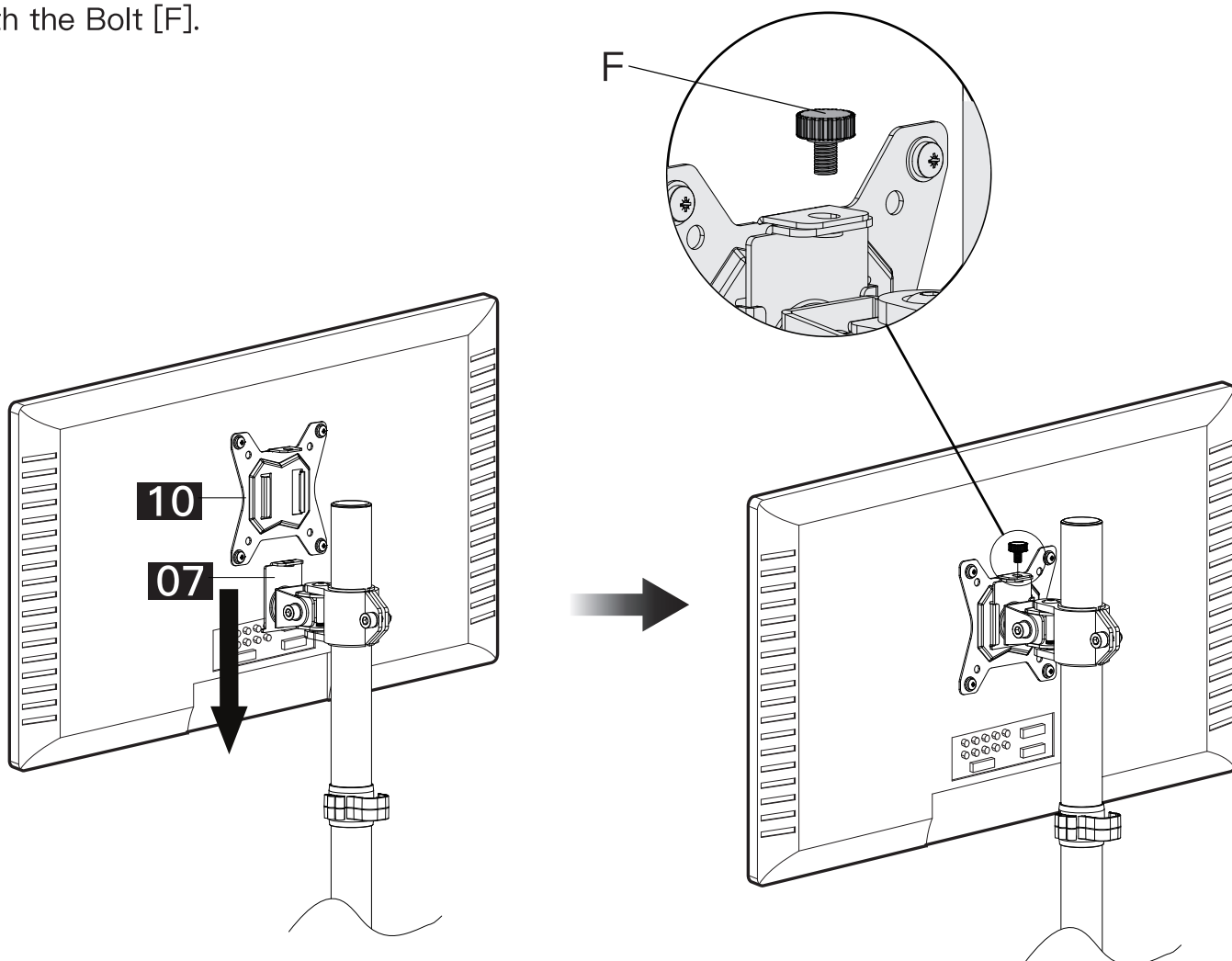

Supplied Hardware for Step 5



Large Allen Key
15/64" (6mm)
09 X 1

Step 5 Monitor Tilt Adjustment

Loosen the bolt, adjust the monitor to your desired angle and tighten the Bolt with the Allen Key [09].

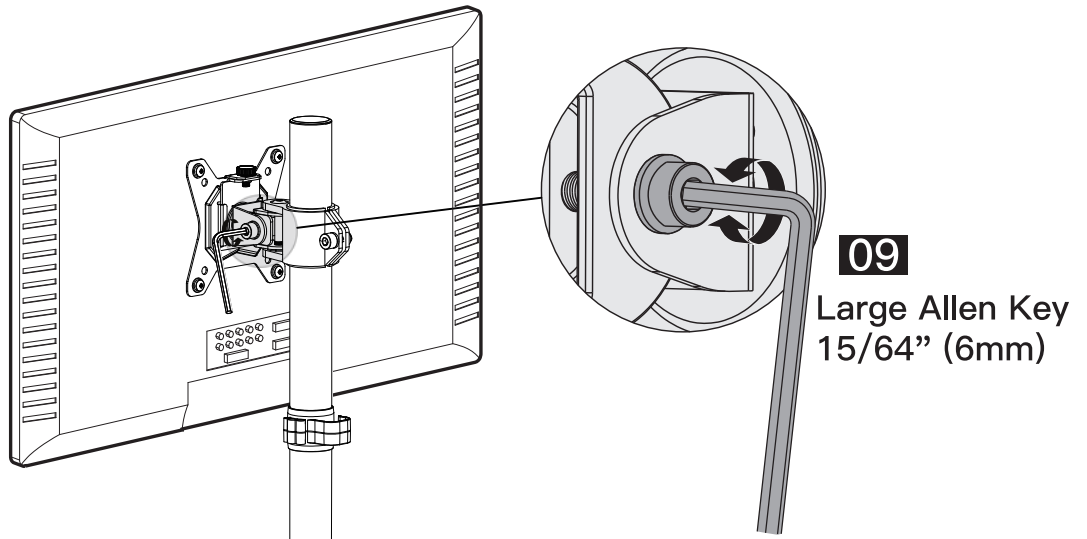

Step 6 Cable Management

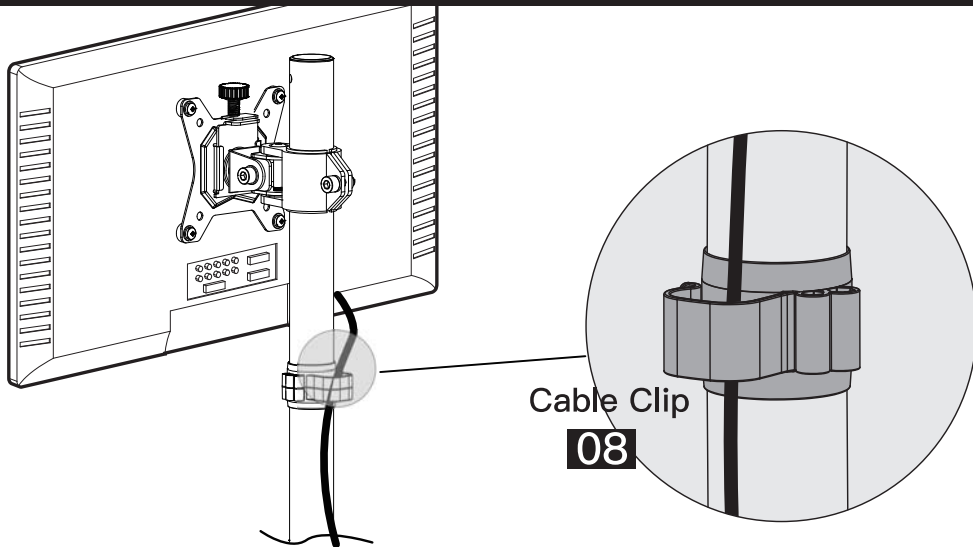

Step 7 Store the Allen Keys into the Cable Clip

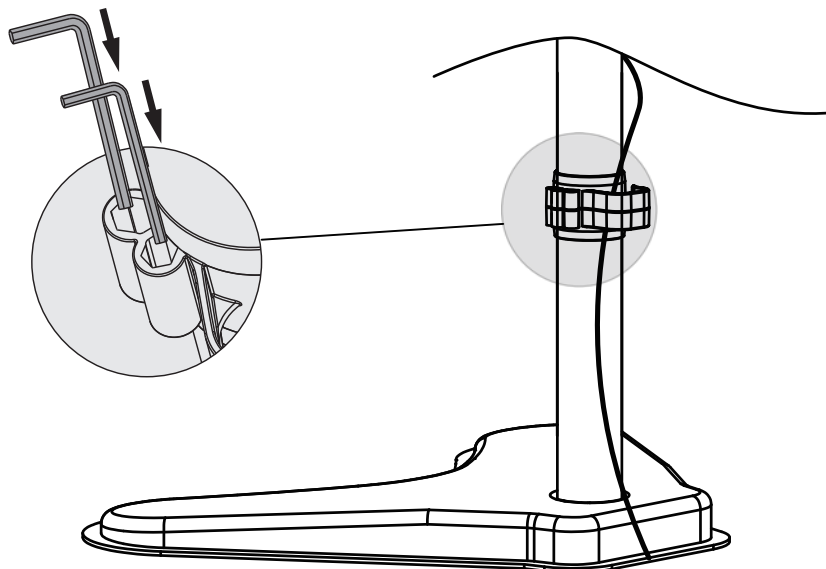

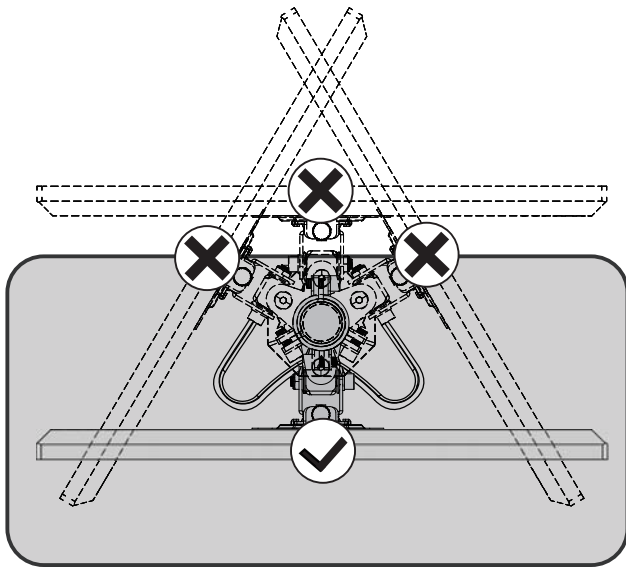

⚠ WARNING:

To avoid tipping, please be careful not to extend the monitor behind the Support Pillar [02]. When you adjust the angle of the monitor, please make sure the monitor is balanced to avoid instability of the center of gravity of the base.

Adjustment Range

Swivel range: $+45^{\circ} \sim -45^{\circ}$

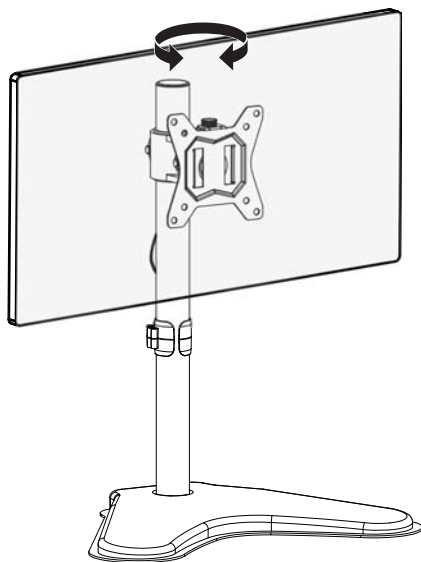

Tilt range: $+15^{\circ} \sim -15^{\circ}$

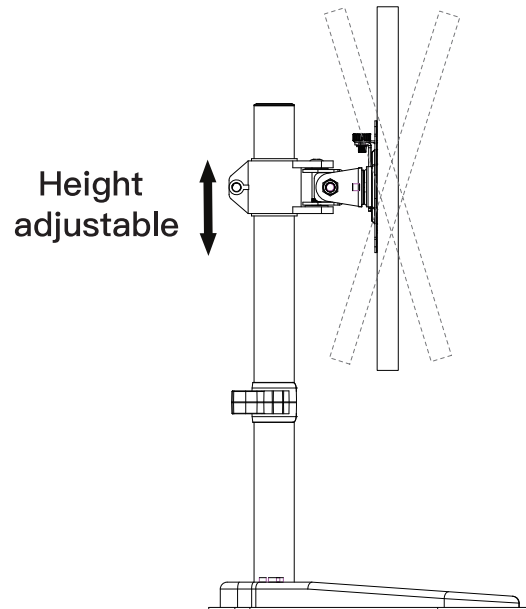

Rotation range: $+180^{\circ} \sim -180^{\circ}$

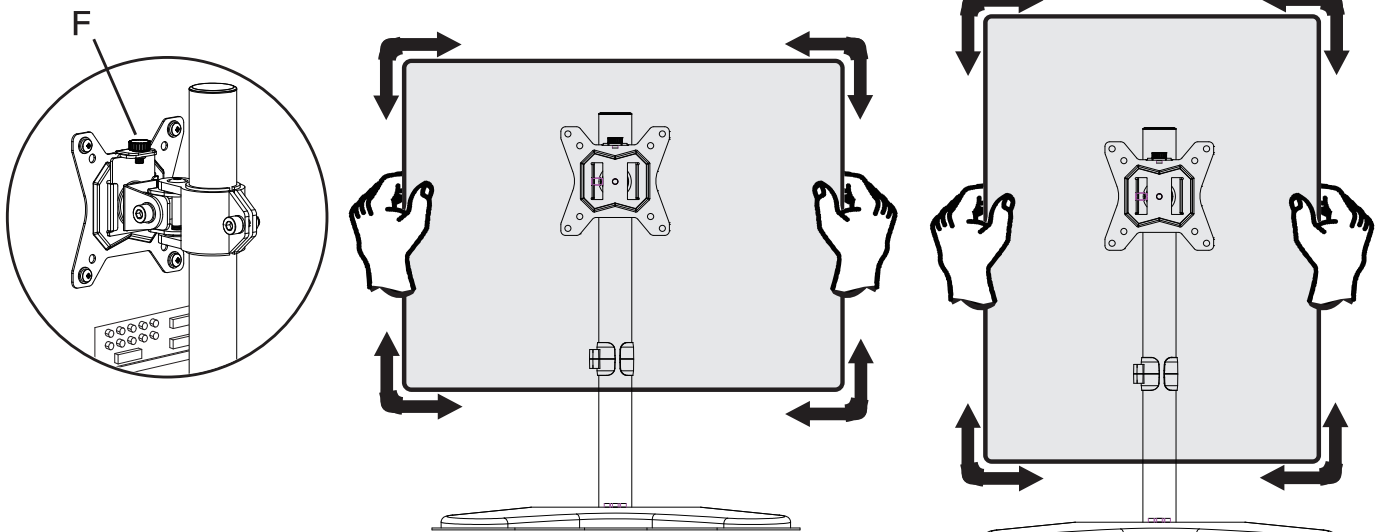

Note: Tighten the Bolt [F] before you rotate the monitor.

CONSIGNES DE SECURITE IMPORTANTES

• Veuillez lire attentivement toutes les instructions avant de tenter l'installation. Si les instructions ne vous semblent pas claires ou si vous avez des questions, veuillez contacter notre service d'assistance technique au (877) 419-7832 ou notre service clientèle à l'adresse support@ergoav.com.

⚠ ATTENTION : Évitez risques de blessures et de dommages matériels!

- N'utilisez pas ce produit à des fins qui ne sont pas explicitement spécifiées dans ce manuel. Ne dépassez pas la capacité de charge. Nous ne sommes pas responsables des dommages ou blessures causés par un montage incorrect, un assemblage incorrect ou une utilisation inappropriée.
- N'utilisez pas ce produit sur des bureaux en panneaux de particules ou autres bois mous.
- Les informations contenues dans ce manuel ne couvrent pas toutes les conditions ou variables possibles en relation avec l'installation de ce produit.

Restrictions de poids



Si votre moniteur pèse plus lourd, ce support n'est PAS compatible. Le moniteur ne doit pas dépasser le poids maximal indiqué.

⚠ AVERTISSEMENT

NE PAS dépasser le poids maximum indiqué. Ce système de montage est destiné à être utilisé uniquement dans les limites des poids maximaux indiqués. L'utilisation de produits plus lourds que les poids maximaux indiqués peut entraîner une défaillance du support et de ses accessoires, causant des dommages et/ou des blessures.

Il est de la responsabilité de l'installateur de vérifier le poids total des moniteurs et de tout accessoire attaché. Ne pas dépasser la limite de poids indiquée.

Vérifiez le motif VESA de votre moniteur avant l'installation

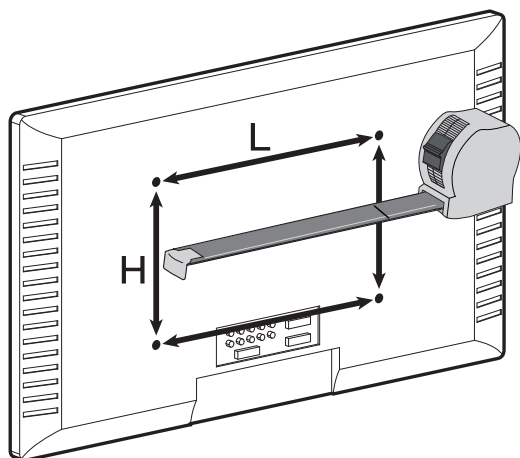

75mm ≈ 3 po
100mm ≈ 4 po

Mesurez le motif VESA de votre moniteur :

Minimum : 75mm x 75mm / 3 po x 3 po (L x H)

Maximum : 100mm x 100mm / 4 po x 4 po (L x H)

Si le motif VESA de votre moniteur est inférieur à 75 mm x 75 mm ou supérieur à 100 mm x 100 mm, ce support n'est PAS COMPATIBLE avec votre moniteur. Veuillez contacter notre support technique au (877) 419-7832 ou support@ergoav.com pour trouver un support compatible.

Outils nécessaires (non inclus)

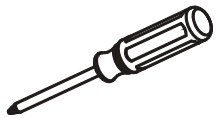

tournevis Phillips

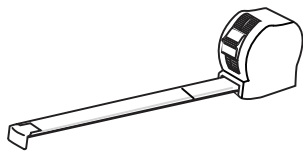

Mètre ruban

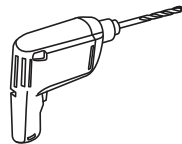

Foreuse
(en option)



Foret à bois
15/32 po – 3/4 po
(12mm – 20mm)
(en option)

Pièces et matériel fournis

⚠ AVERTISSEMENT : Ce produit contient des petits objets susceptibles de présenter un risque d'étouffement en cas d'ingestion.

Avant de commencer l'assemblage, vérifiez que toutes les pièces sont incluses et en bon état. N'utilisez pas de pièces endommagées ou défectueuses. Si vous avez besoin de pièces de rechange, veuillez contacter notre ligne d'assistance technique au (877) 419-7832 ou notre service clientèle à l'adresse support@ergoav.com.

• Noter : le matériel inclus dans cet ensemble ne sera pas utilisé en totalité.

Pièces et matériel fournis pour l'étape 1



Base

01 X 1



Pilier support

02 X 1

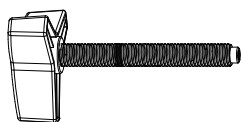

Poignées

03 X 1



Plaque de passe-fils

04 X 1



Petite clé Allen 5/32 po (4mm)

05 X 1

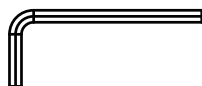

Clé Allen moyenne 3/16 po (5mm)

06 X 1



Boulon

A X 3

Étape 1 Installation du pilier support

Alignez les trous de la base [01] avec les trous du pilier support [02] et fixez-les avec les trois boulons [A] et la clé Allen [05].

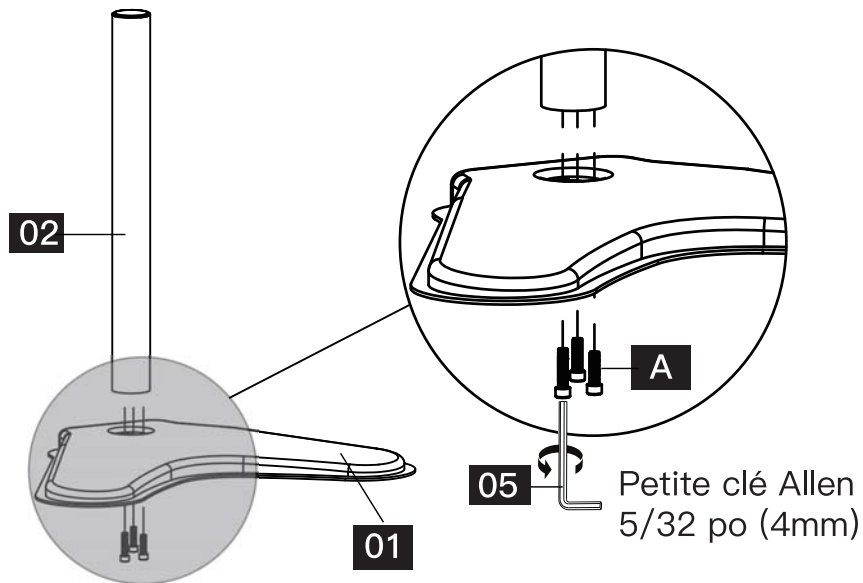

Sélectionnez l'option en fonction de vos besoins

Option A Base autonome

Vous pouvez passer à l'étape 2.

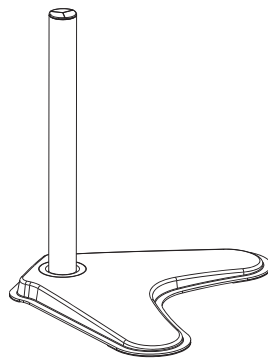

Option B Trou d'œillet existant

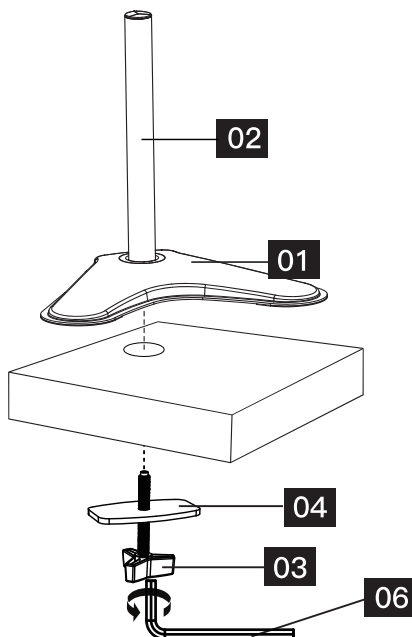

Positionnez l'ensemble de la base [01] et [02] sur la surface de montage et fixez-le à l'aide de la plaquette de passe-fils [04] et du poignées [03]. Serrez le poignées [03] à l'aide de la clé Allen [06] fournie.

REMARQUE : Si votre bureau est doté d'un trou d'œillet existant avec un couvercle en plastique, retirez-le avant l'installation.

Pour l'épaisseur du bureau :
3/4 po – 1 1/2 po (20mm à 40mm)

Clé Allen moyenne 3/16 po (5mm)

Option C Trou d'oeillet auto-percé

1. Faites une marque pour le trou central sur votre surface de montage. Utilisez une mèche de 15/32 po (12mm) minimum et de 3/4 po (20mm) maximum et percez un trou dans la surface de montage.

2. Positionnez le centre de l'ensemble de base [01] et [02] sur le trou percé dans la surface de montage et fixez-le à l'aide de la plaquette de passe-fils [04] et du poignées [03]. Serrez le poignées [03] à l'aide de la clé Allen [06] fournie.

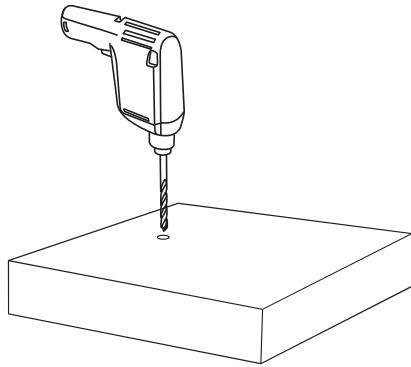

Pour l'épaisseur du bureau :
3/4 po – 1 1/2 po (20mm à 40mm)

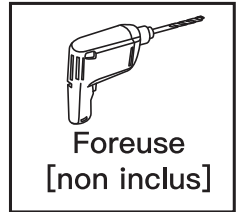
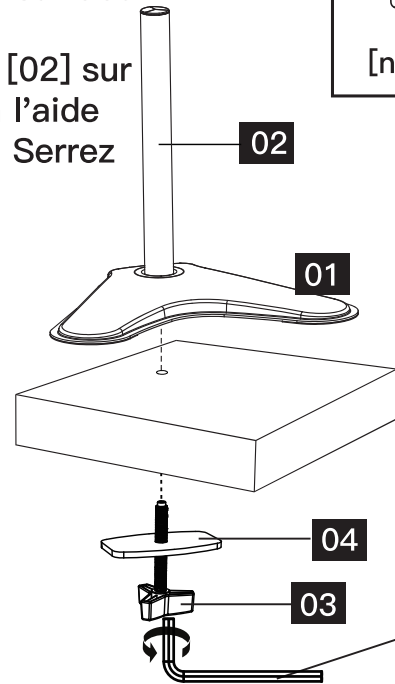

Clé Allen moyenne 3/16 po (5mm)

Pièces et matériel fournis pour l'étape 2

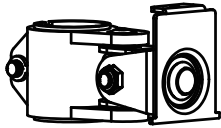

Connecteur du moniteur

07 X 1

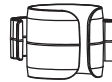

Pince à câble

08 X 1

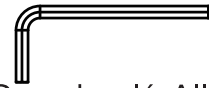

Grande clé Allen
15/64 po (6mm)

09 X 1

Étape 2 Fixer le pince à câble et le connecteur du moniteur au pilier support

Étape 2-1

Faites glisser le pince à câble [08] et le connecteur du moniteur [07] sur le pilier support [02].

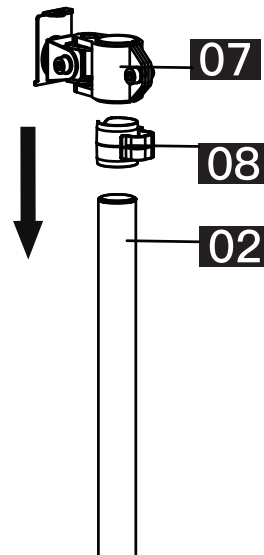

Étape 2-2

Fixez le connecteur du moniteur [07] au pilier support [02] en utilisant la clé Allen [09] pour serrer le boulon.

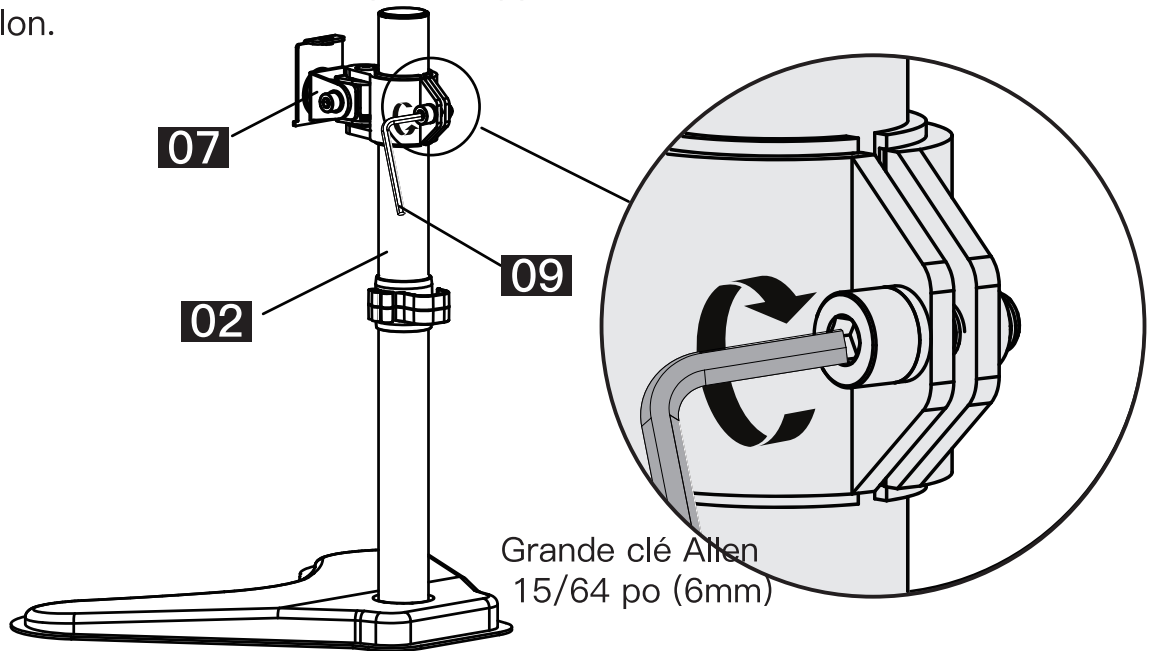

Avant de commencer l'étape 3, assurez-vous que la tête du connecteur du moniteur [07] est verticale en faisant glisser la plaque de moniteur [10] et en l'ajustant jusqu'à ce qu'elle soit verticale.

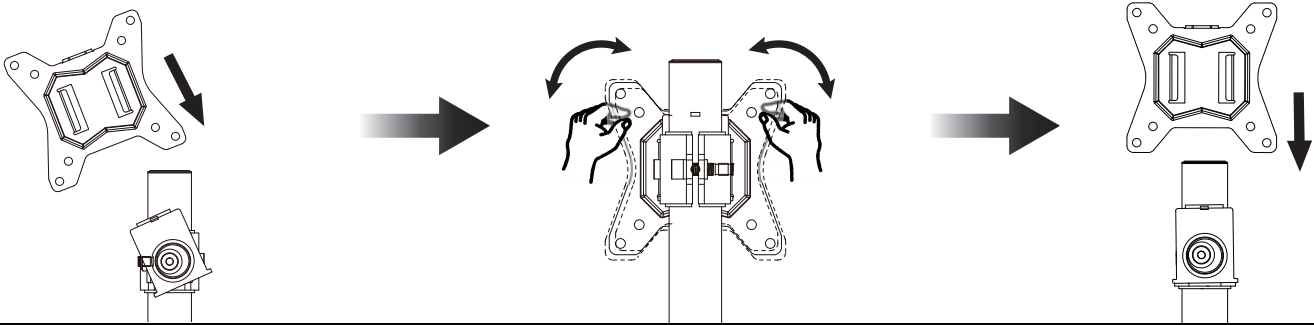

Pièces et matériel fournis pour l'étape 3

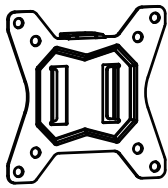

Plaque de moniteur

10 X 1

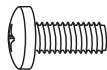

Boulon
M4 x 12mm
B X 4

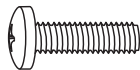

Boulon
M4 x 30mm
C X 4

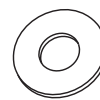

Rondelle D4
D X 4



13mm Entretoises
E X 4

Étape 3 Fixation de la plaque de moniteur

Une seule taille de boulon convient à votre moniteur.

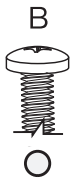

M4 x 12mm



M4 x 30mm

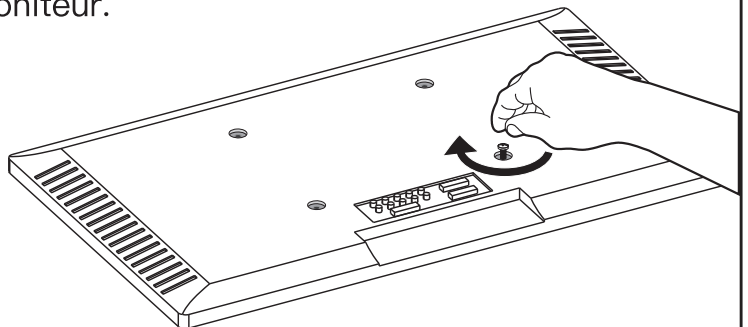

Longueur de la vis : vérifiez que le filetage est correctement engagé avec les boulons ou la combinaison vis / entretoises. Nous recommandons un engagement du filetage sur au moins 5 tours.

- Trop court, le TV ne sera pas maintenu.
- Trop long, le TV sera endommagé.

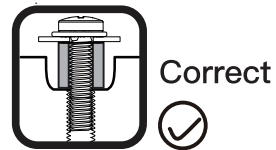
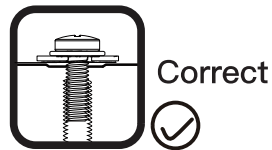
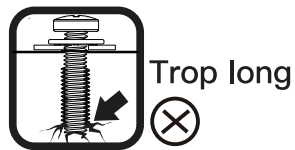
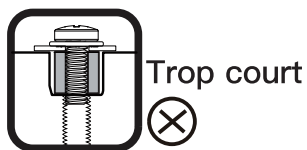

Option A (pour moniteur à dos plat)

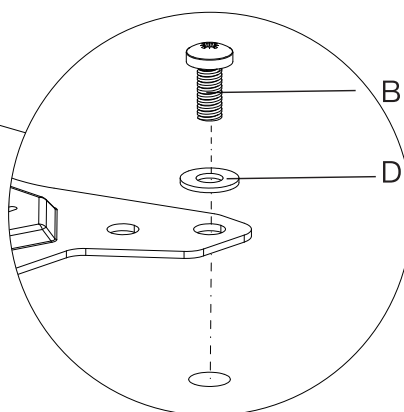
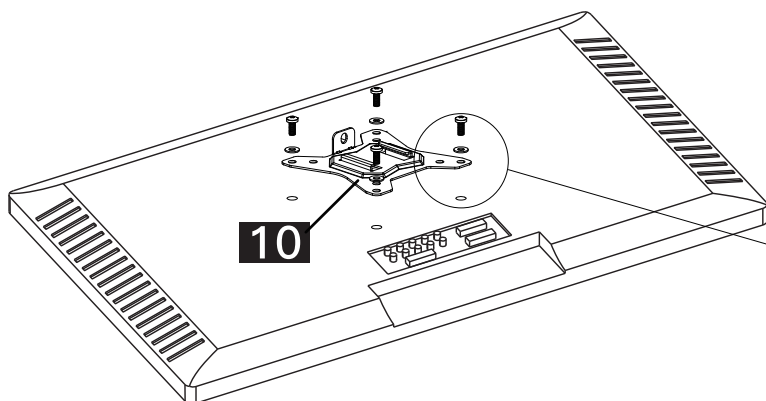

Tournevis
Phillips
(non inclus)

Option B (pour moniteur à dos incurvé)

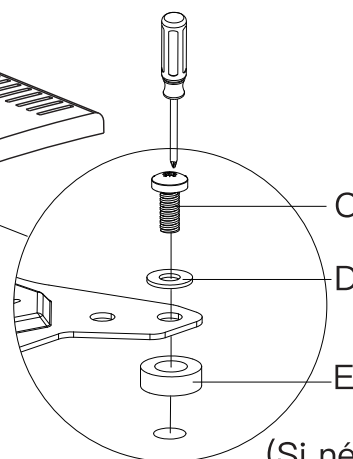
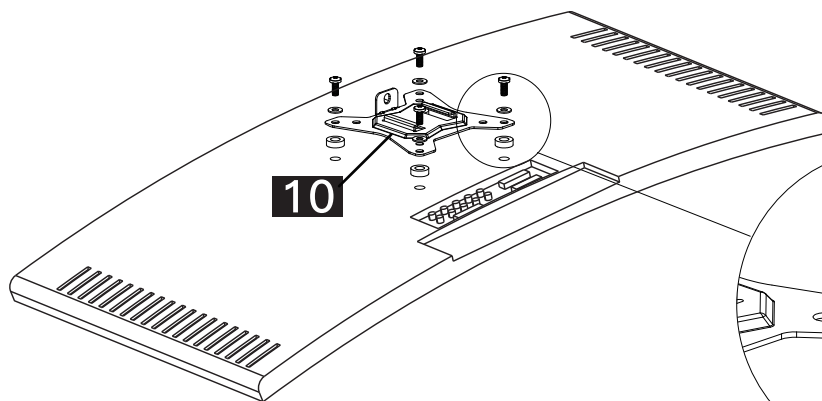

(Si nécessaire)



Tournevis
Phillips
(non inclus)

Matériel fourni pour l'étape 4



Boulon
F X 1

Étape 4 Fixer le moniteur au support

Faites glisser la plaque de moniteur [10] sur le connecteur du moniteur [07] et fixez-la avec le boulon [F].

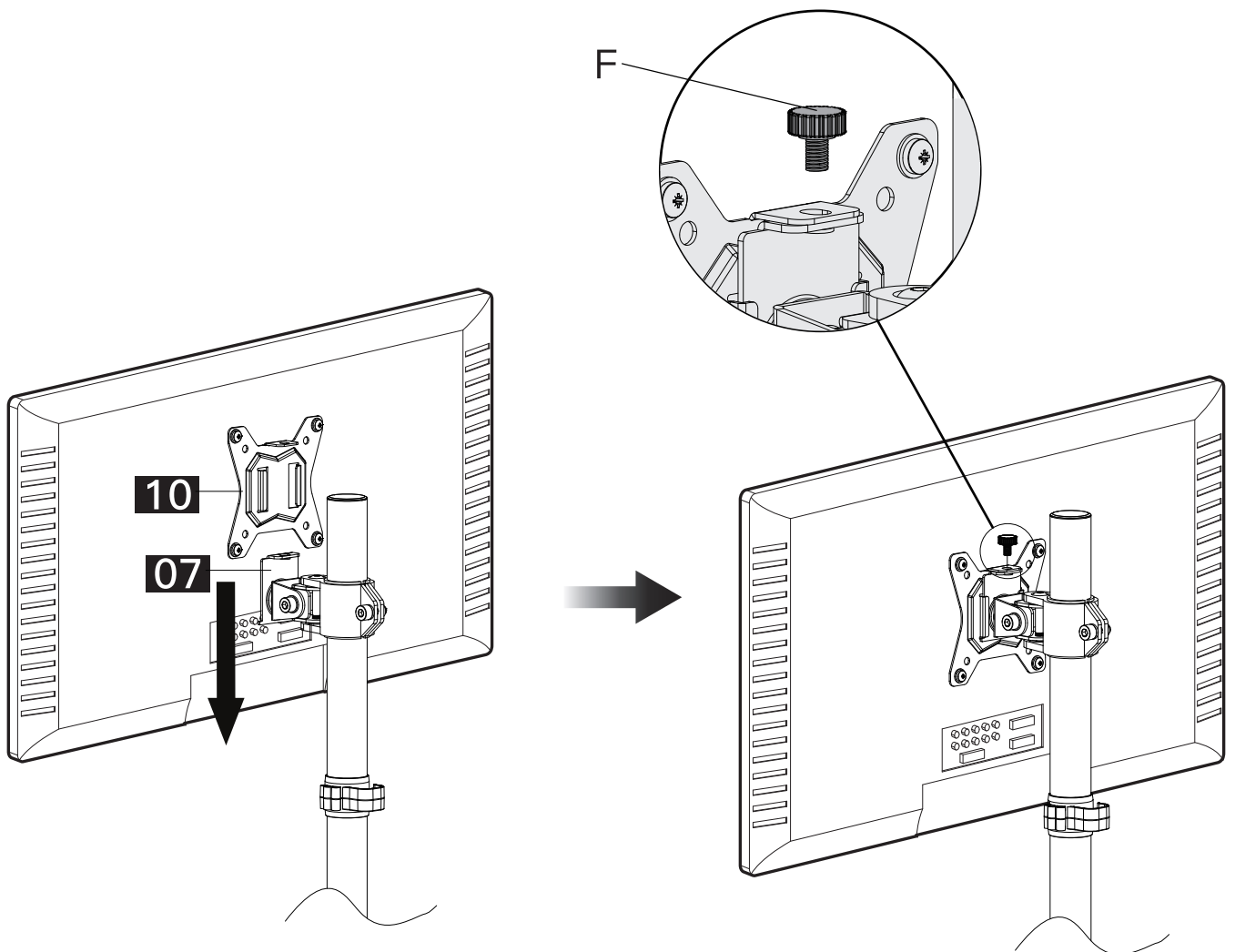

Matériel fourni pour l'étape 5



Grande clé Allen
15/64 po (6mm)

09 X 1

Étape 5 Réglage de l'inclinaison du moniteur

Desserrez le boulon, réglez le moniteur à l'angle souhaité et serrez le boulon avec la clé Allen [09].

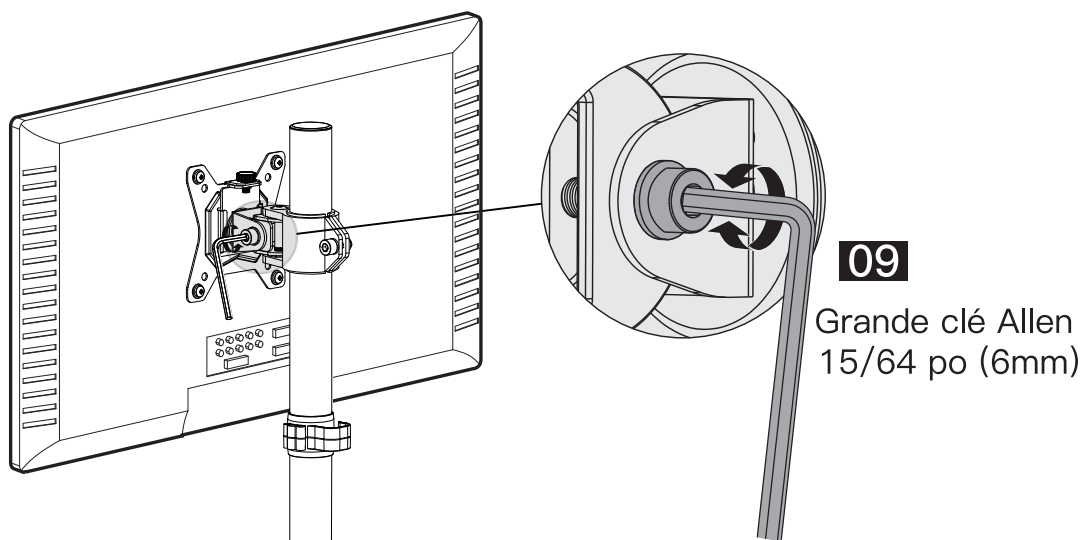

Étape 6 Gestion des câbles

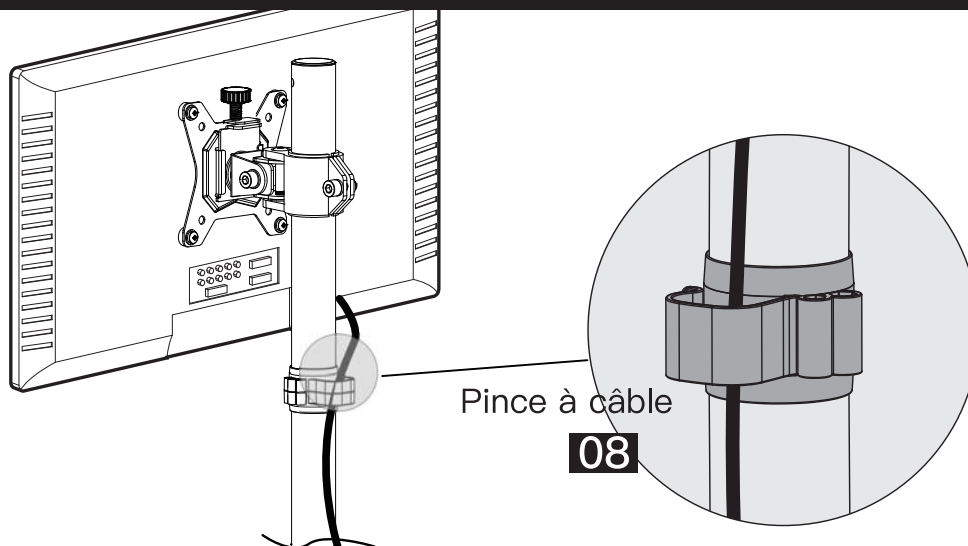

Étape 7 Rangement des clés Allen dans le pince à câble

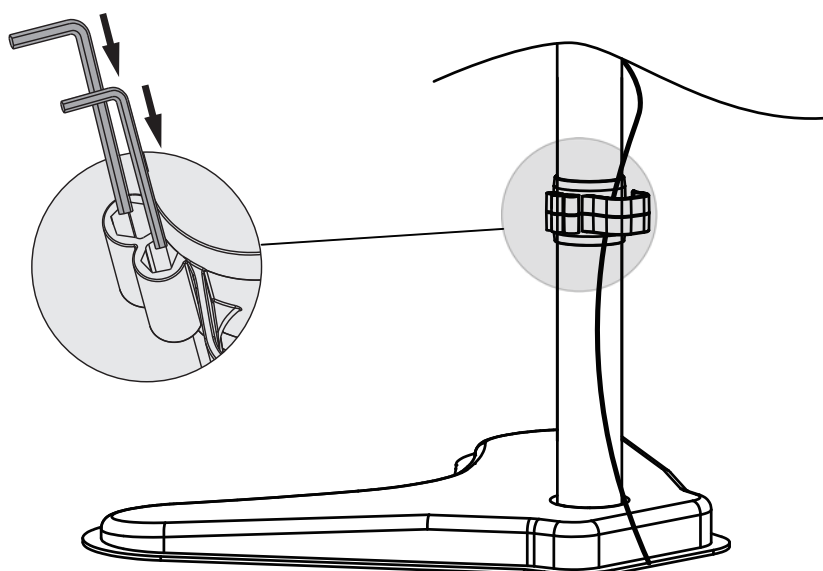

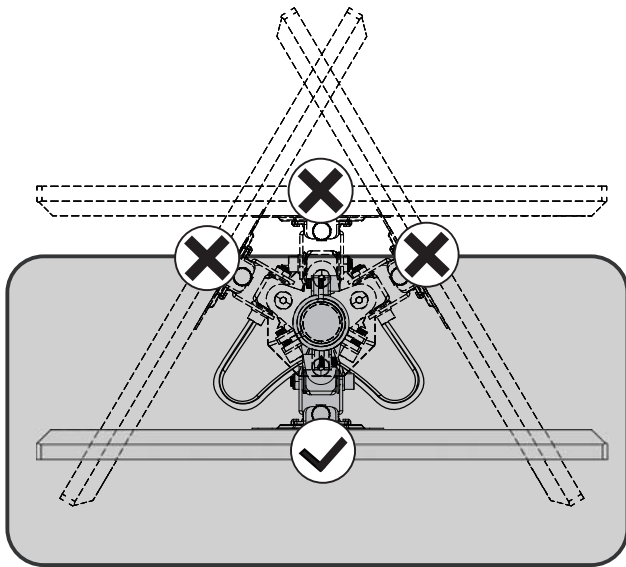

⚠ AVERTISSEMENT :

Pour éviter de basculer, veuillez à ne pas étendre le moniteur derrière le pilier de support [02]. Lorsque vous réglez l'angle du moniteur, veuillez vous assurer que le moniteur est équilibré pour éviter l'instabilité du centre de gravité de la base.

Plage de réglage

Plage de pivotement : $+45^\circ$ à -45°

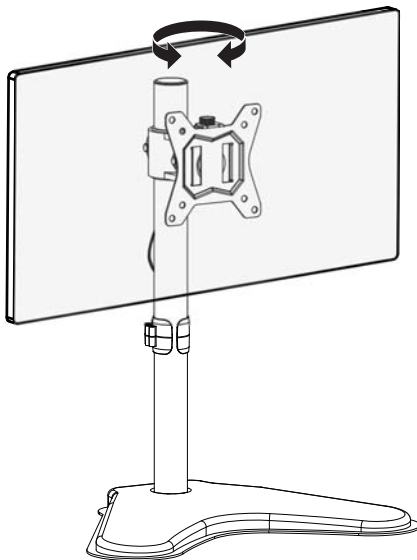

Plage d'inclinaison : $+15^\circ$ à -15°

réglable
en hauteur

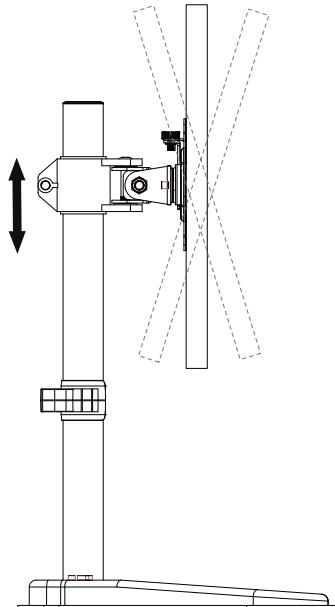

Plage de rotation : $+180^\circ$ à -180°

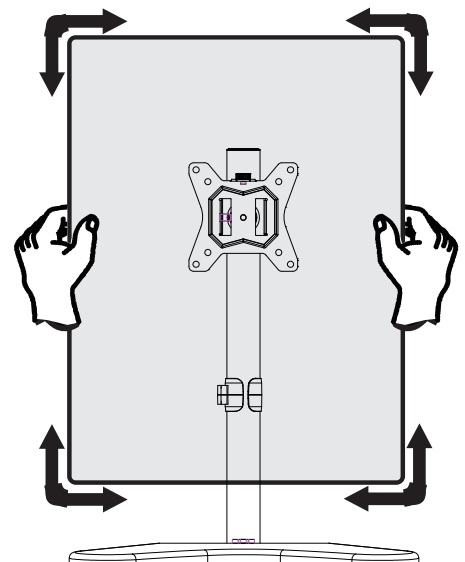
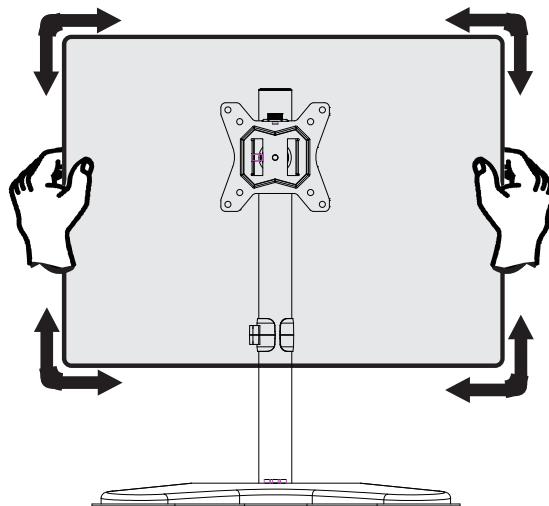
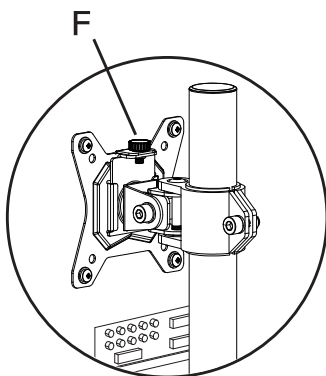

Note : Serrez le boulon [F] avant de faire pivoter le moniteur.

INFORMACIÓN IMPORTANTE DE SEGURIDAD

• Lea todas las instrucciones detenidamente antes de proceder a la instalación. Si no entiende las instrucciones o tiene alguna duda o consulta, póngase en contacto con nuestra línea de asistencia técnica llamando al (877) 419-7832, o escribiendo al servicio de atención al cliente en Support@ergoav.com.

⚠ **PRECAUCIÓN:** ¡Evite posibles lesiones y daños materiales!

- No utilice este producto con ningún fin que no sea el especificado explícitamente en este manual. No supere la capacidad de peso. No nos hacemos responsables de posibles daños o lesiones causados por un montaje incorrecto, errores de ensamblaje o uso inadecuado.
- No use este producto en escritorios fabricados con tableros de aglomerado u otras maderas suaves.
- La información contenida en este manual no cubre todas las condiciones o variables posibles en relación con la instalación de este producto.

Límites de peso



Si su monitor pesa más, este soporte NO es compatible. El monitor no debe exceder el peso máximo que se enumera.

⚠ ADVERTENCIA

NO exceda el límite máximo indicado de peso. Solo se puede utilizar este sistema de soporte si se no se sobrepasa los pesos máximos indicados. Si se utiliza con productos que sobrepasan los pesos máximos indicados es posible que el soporte y sus accesorios tengan fallas, y provoquen daños y/o lesiones.

Queda a responsabilidad del instalador verificar el peso total de los monitores y de cualquier accesorio acoplado. No se debe exceder del límite de peso establecido. No se debe exceder del límite de peso establecido.

Compruebe el patrón VESA de su monitor antes de realizar la instalación

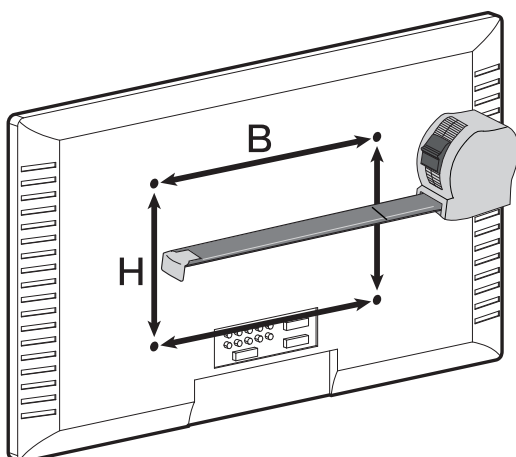

75mm ≈ 3 pulg
100mm ≈ 4 pulg

Mida el patrón VESA de su monitor:

Mínimo: 75mm x 75mm / 3 pulg x 3 pulg (ancho x alto)
Máximo: 100mm x 100mm / 4 pulg x 4 pulg (ancho x alto)

Si el patrón VESA de su monitor mide menos de 75 mm x 75 mm o es más grande que 100 mm x 100 mm, este soporte NO ES COMPATIBLE con su monitor. Contáctese con nuestro soporte técnico al (877) 419-7832 o en support@ergoav.com para encontrar un montaje compatible.

Herramientas necesarias (no incluidas)

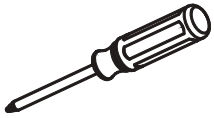

destornillador Phillips

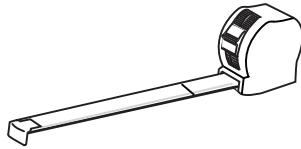

Cinta métrica

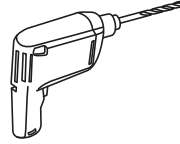

Taladro
(Opcional)



Broca para madera de

15/32 pulg – 3/4 pulg (12mm – 20mm)
(opcional)

Piezas y herramientas provistas

⚠ ADVERTENCIA: Este producto contiene piezas pequeñas que pueden representar un riesgo de atragantamiento si se ingieren.

Antes de iniciar el montaje, compruebe que todas las piezas estén incluidas e intactas. No utilice piezas dañadas o defectuosas. Si necesita piezas de repuesto, póngase en contacto con nuestra línea de asistencia técnica al (877) 419-7832 o con el servicio de atención al cliente en support@ergoav.com

- Tenga en cuenta lo siguiente: Es posible que no necesite usar todos los herrajes incluidos en este envase.

Piezas y herrajes suministrados para el paso 1



Base

01 X 1

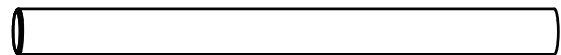

Pilar de soporte

02 X 1

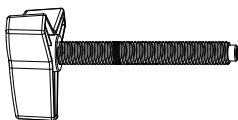

Perillas

03 X 1



Placa de ojal

04 X 1



Llave Allen pequeña
5/32 pulg (4mm)

05 X 1

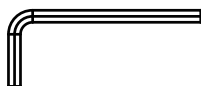

Llave Allen mediana
3/16 pulg (5mm)

06 X 1



Pernos

A X 3

Paso 1 Instale el pilar de soporte

Alinee los agujeros de la Base [01] con los agujeros del Pilar de Soporte [02] y asegúrelos con los tres Pernos [A] y la Llave Allen [05].

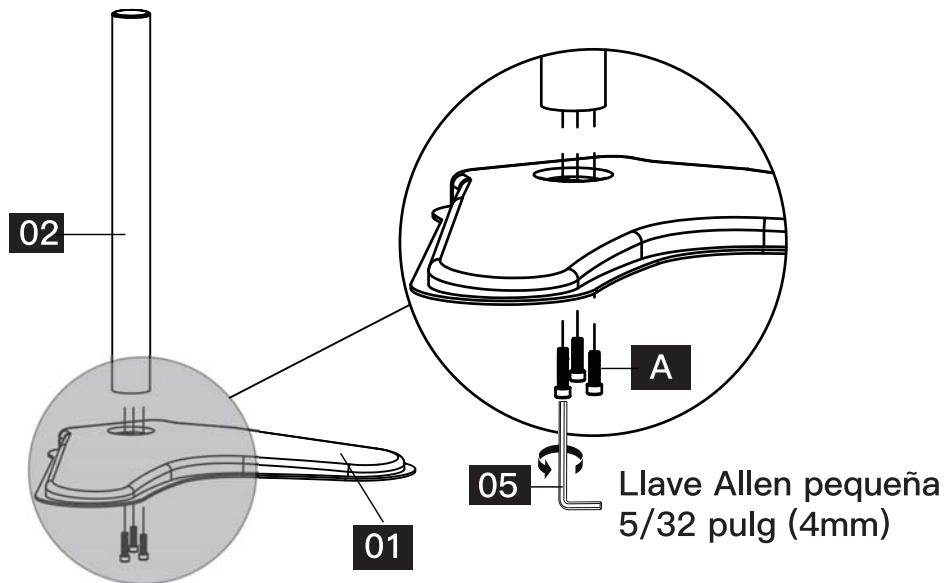

Seleccione la mejor opción según sus necesidades

Option A Base Independiente

Siga con el Paso 2.

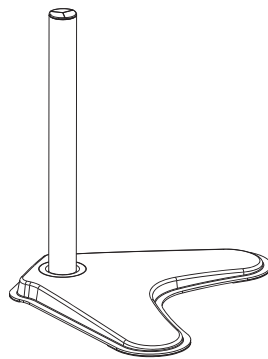

Option B Agujero de ojal existente

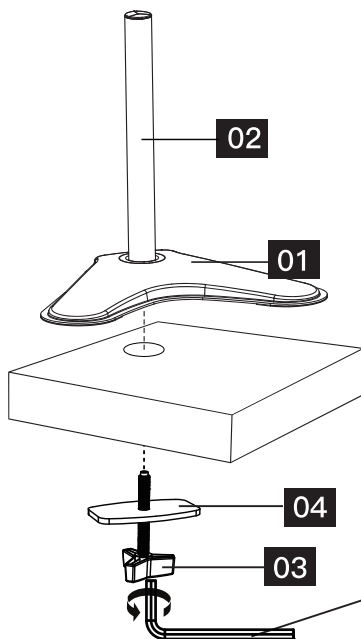

Coloque el conjunto de la base [01] y [02] en la superficie de montaje y fíjelo con la placa de ojal [04] y la perilla [03]. Apriete la perilla [03] con la llave Allen [06] suministrada.

NOTA: Si su escritorio tiene un agujero de ojal existente con una cubierta de plástico, retírelo antes de realizar la instalación.

Para espesor de escritorio:
3/4 pulg – 1 1/2 pulg (20mm à 40mm)

Llave Allen mediana
3/16 pulg (5mm)

Option C Agujero de ojal auto perforado

1. Haga una marca para el agujero central en su superficie de montaje. Utilice una broca de 15/32 pulg (12mm) como mínimo y de 3/4 pulg (20mm) como máximo y perforo un agujero en la superficie de montaje.
2. Coloque el centro del conjunto de la base [01] y [02] sobre el orificio perforado en la superficie de montaje y fíjelo utilizando la placa de ojal [04], la perilla [03]. Apriete la perilla [03] con la llave Allen [06] suministrada.

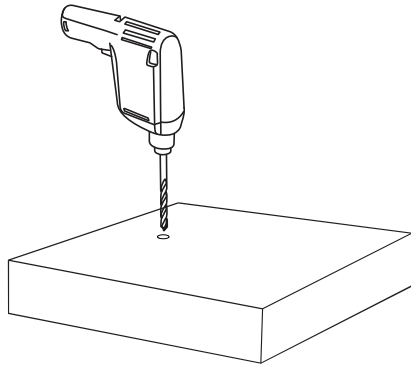

Para espesor de escritorio:
3/4 pulg – 1 1/2 pulg (20mm à 40mm)

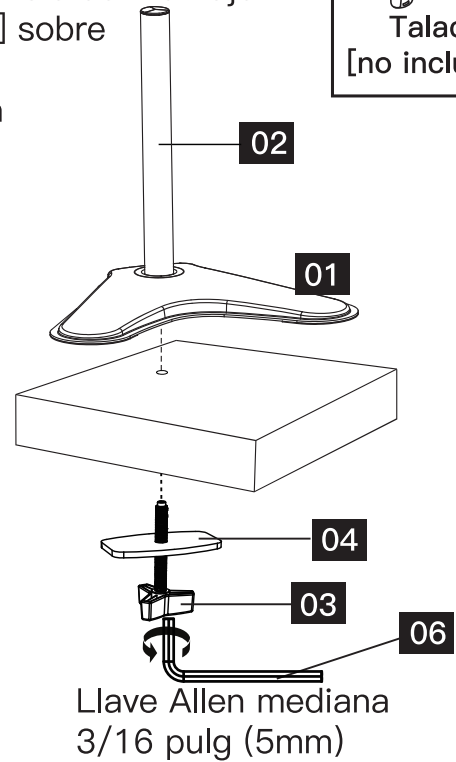

Piezas y hardware suministrados para el Paso 2

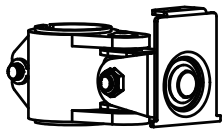

Conector del monitor

07 X 1



Clip de cable

08 X 1

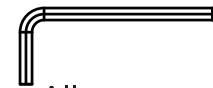

Llave Allen grande
15/64 pulg (6mm)

09 X 1

Paso 2 Coloque el clip de cable y el conector del monitor en el pilar de soporte

Paso 2-1

Deslice el clip de cable [08] y el conector del monitor [07] en el pilar de soporte [02].

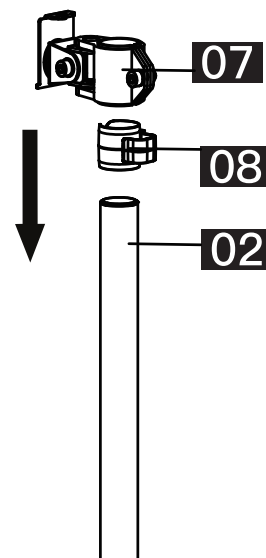

Paso 2-2

Fije el conector del monitor [07] al pilar de soporte [02] utilizando la llave Allen [09] para apretar el perno.

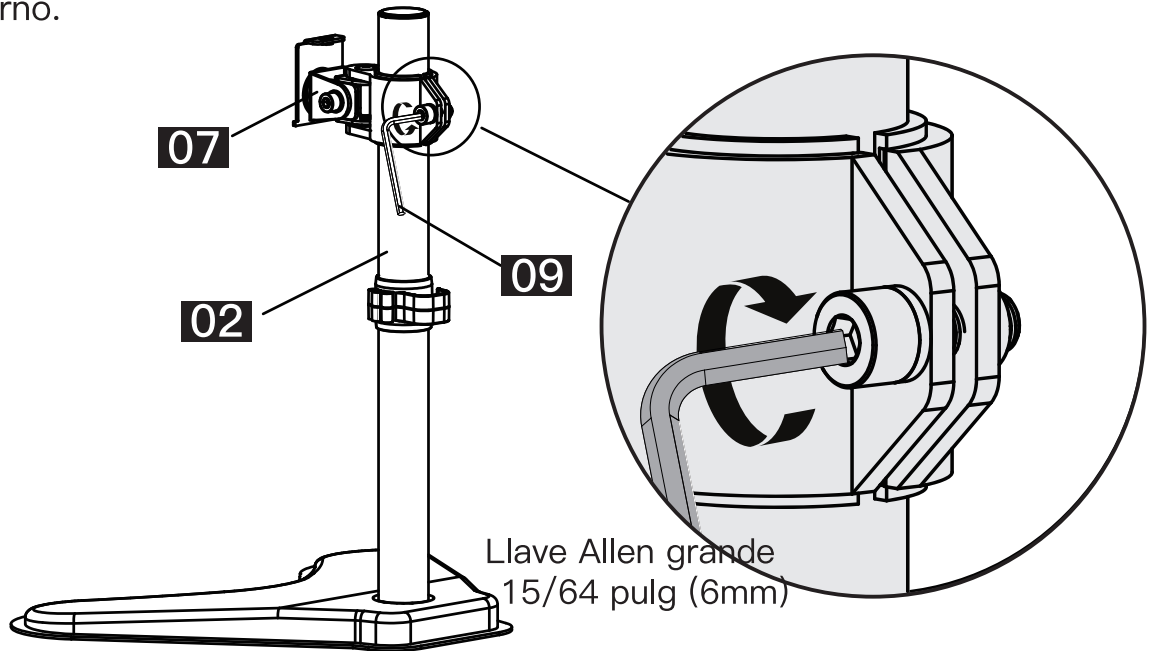

Antes de comenzar con el Paso 3, asegúrese de que la cabeza del conector del monitor [07] esté en posición vertical deslizando la placa de monitor [10] y ajustándola hasta que esté en posición vertical.

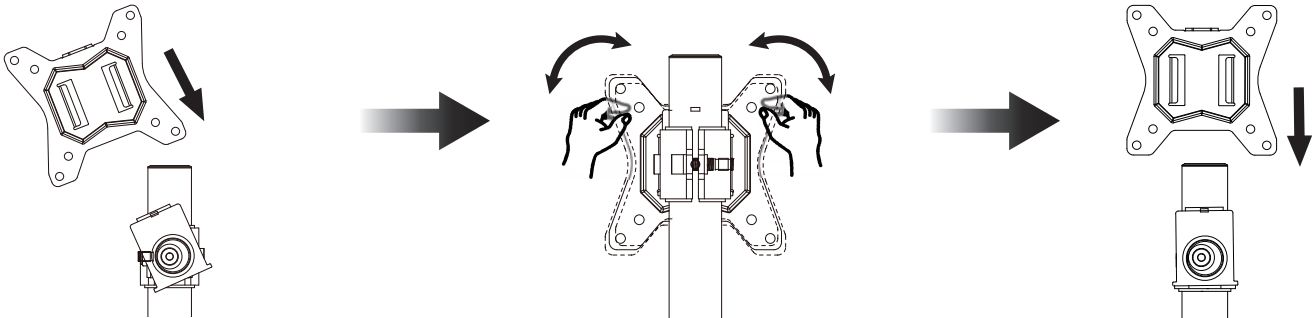

Piezas y herrajes suministrados para el paso 3

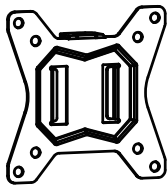

Placa de monitor

10 X 1

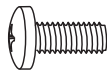

Pernos
M4 x 12mm
B X 4

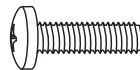

Pernos
M4 x 30mm
C X 4



Arandela D4
D X 4



13mm Espaciadores
E X 4

Paso 3 Coloque la placa de monitor

Sólo un tamaño de perno se ajusta a su monitor.

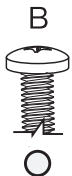

M4 x 12mm



M4 x 30mm

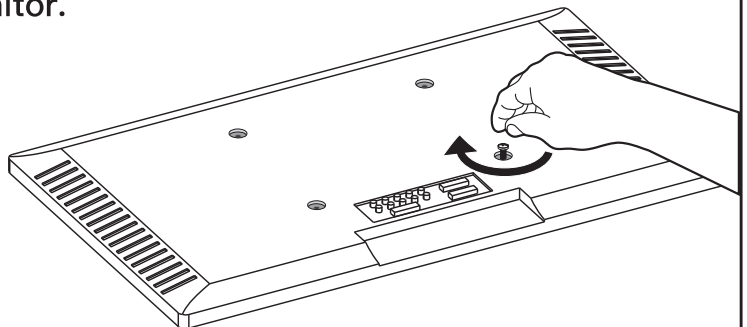

Longitud del tornillo: Compruebe que la rosca encaje correctamente con los tornillos o la las combinaciones de tornillo / espaciador. Se recomienda enganchar las roscas con 5 vueltas como mínimo.

- Demasiado corto, no sostendrá el TV.
- Demasiado largo, dañará el TV.

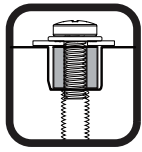

Demasiado corto

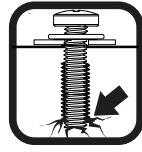

Demasiado largo

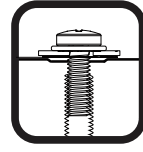

Correcto

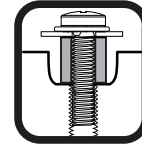

Correcto



Opción A (para monitor con respaldo plano)

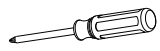
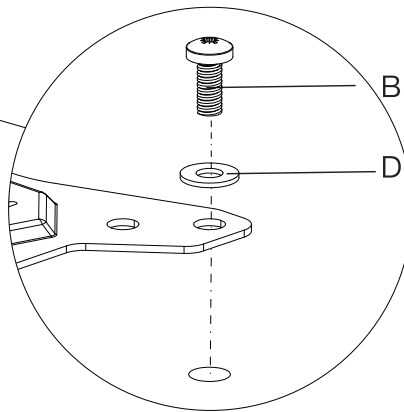
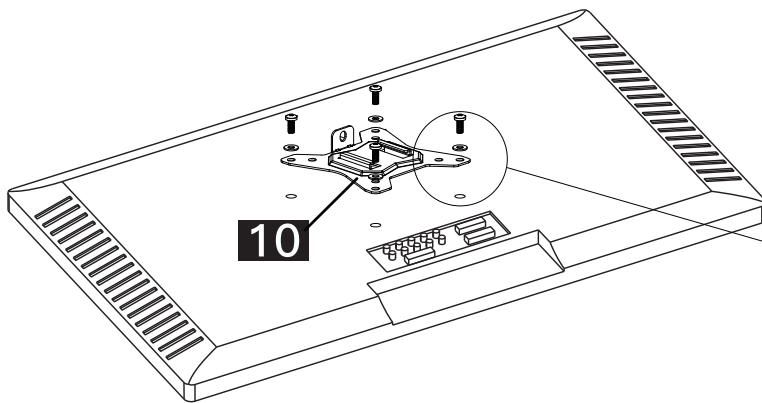

Destornillador
Phillips
(no incluido)

Opción B (para monitor con respaldo curvo)

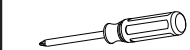
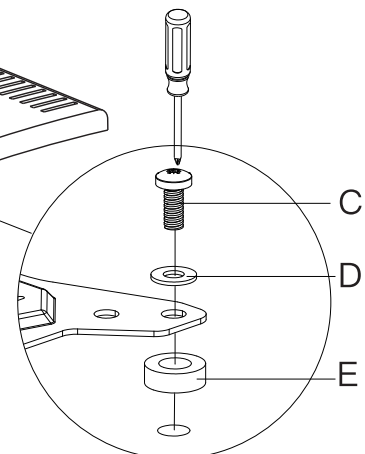
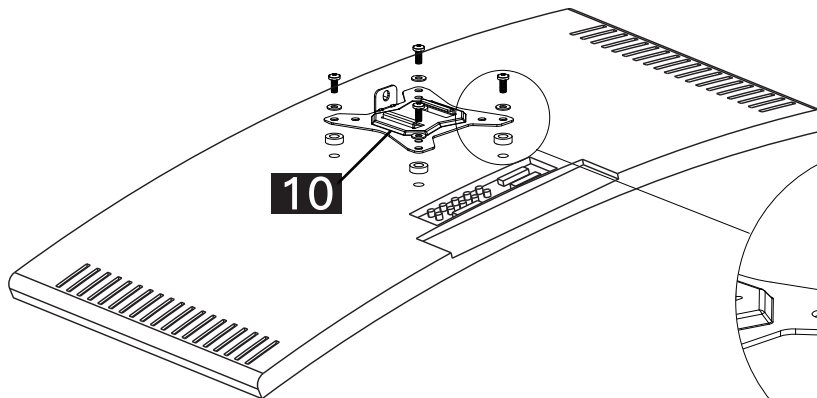

Destornillador
Phillips
(no incluido)

(si son necesarios)

Hardware suministrado para el paso 4



Pernos

F X 1

Paso 4 Coloque el monitor en el soporte

Deslice la placa de monitor [10] en el conector del monitor [07] y fíjela con el perno [F].

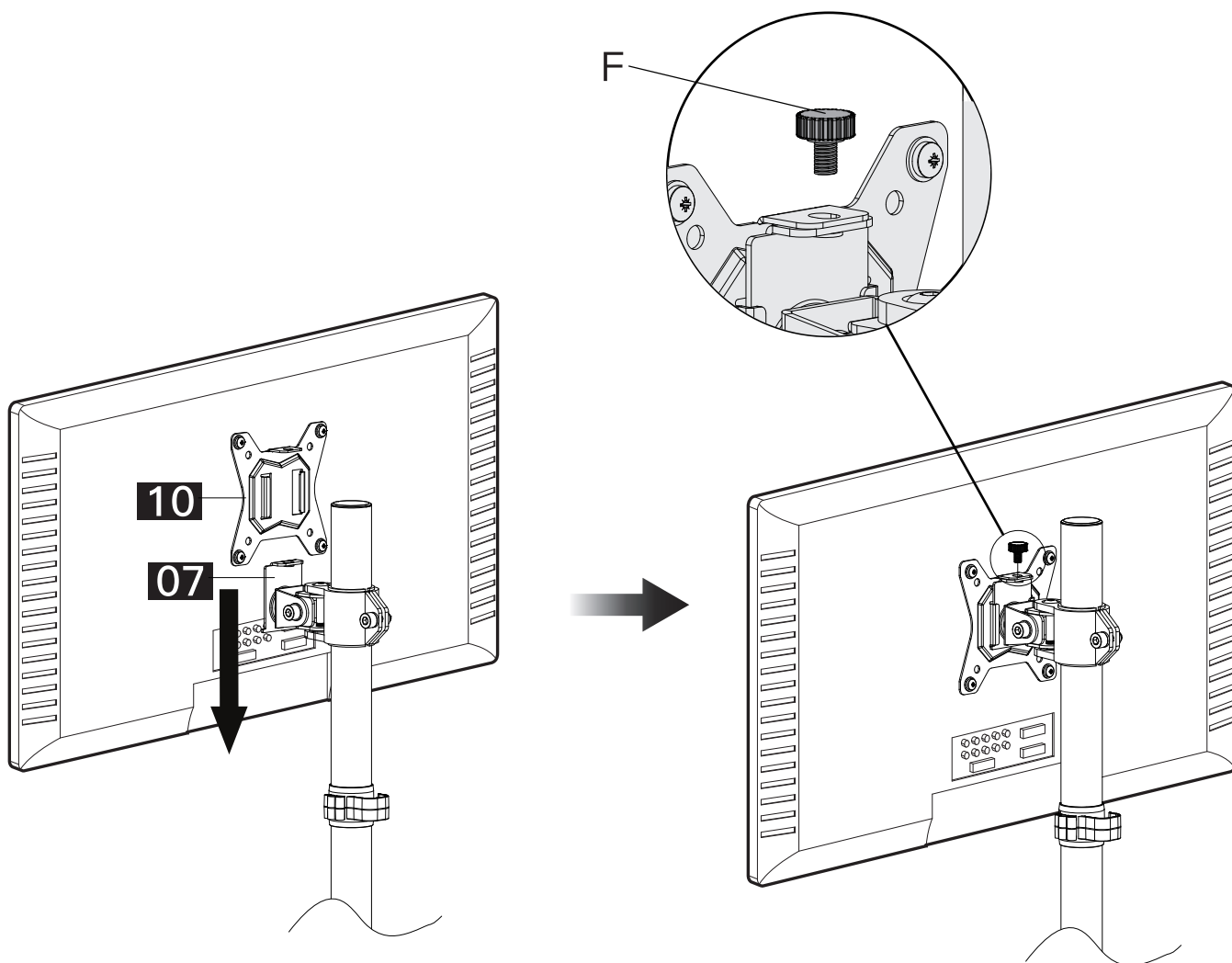

Hardware suministrado para el paso 5



Llave Allen grande
15/64 pulg (6mm)

09 X 1

Paso 5 Ajuste de la inclinación del monitor

Afloje el perno, ajuste el monitor en el ángulo deseado y apriete el perno con la llave Allen [09].

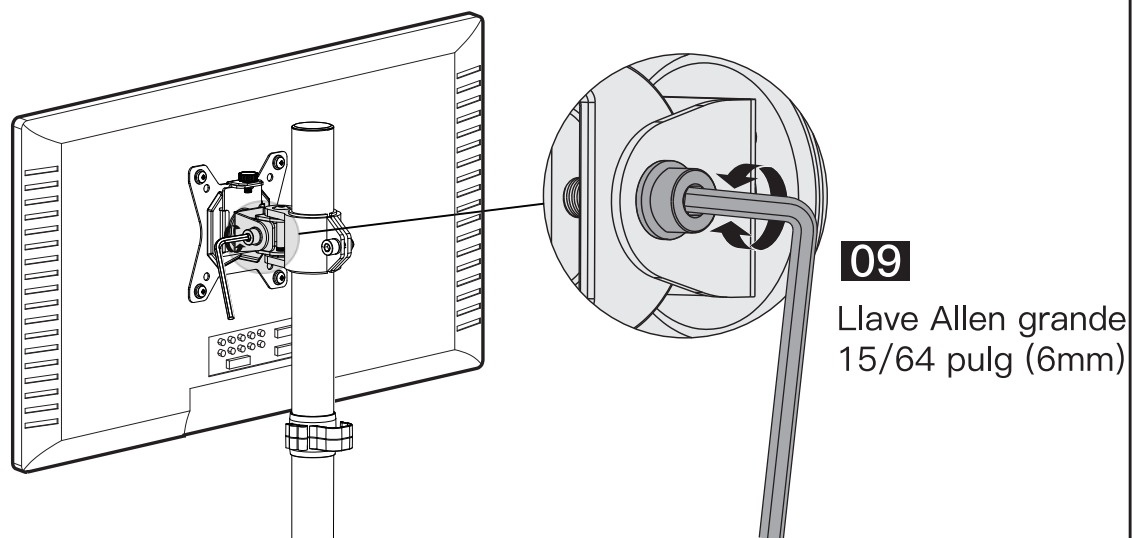

Paso 6 Gestión de los cables

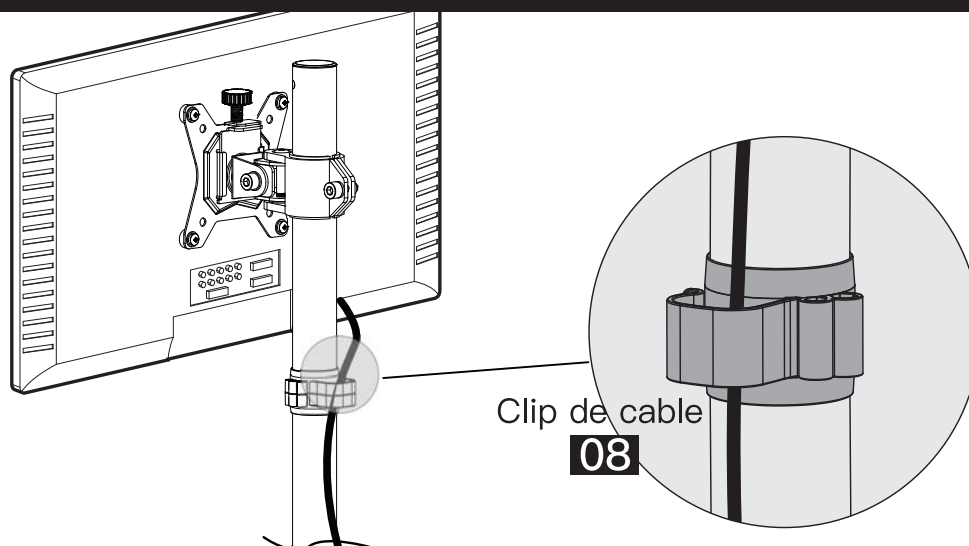

Paso 7 Guarde las llaves Allen en el clip de cable

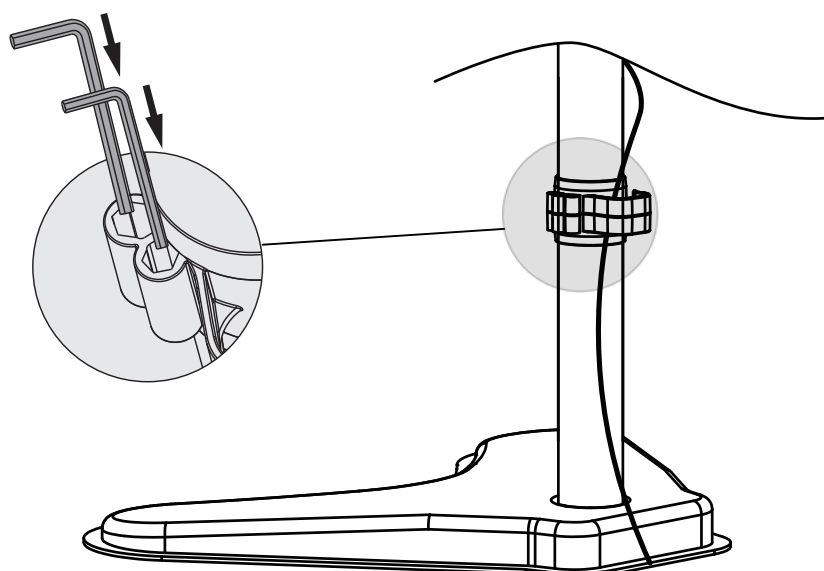

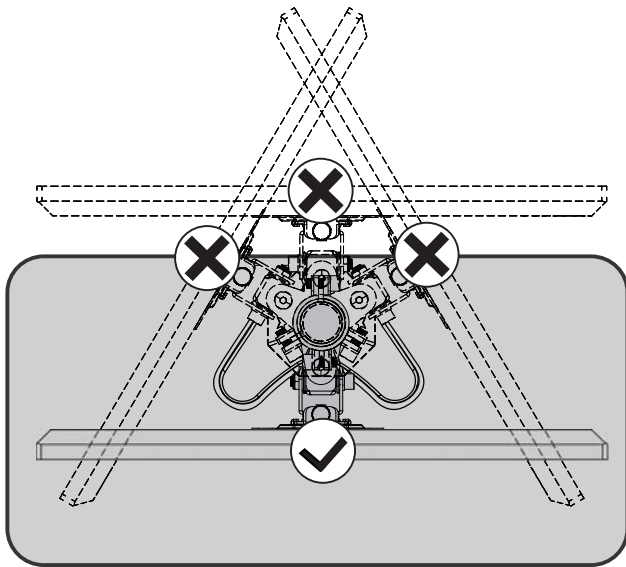

⚠ ADVERTENCIA:

Para evitar volcaduras, tenga cuidado de no extender el monitor detrás del pilar de soporte [02]. Cuando ajuste el ángulo del monitor, asegúrese de que el monitor esté correctamente equilibrado para evitar la inestabilidad del centro de gravedad de la base.

Rango de ajuste

Rango de giro: $+45^\circ$ a -45°

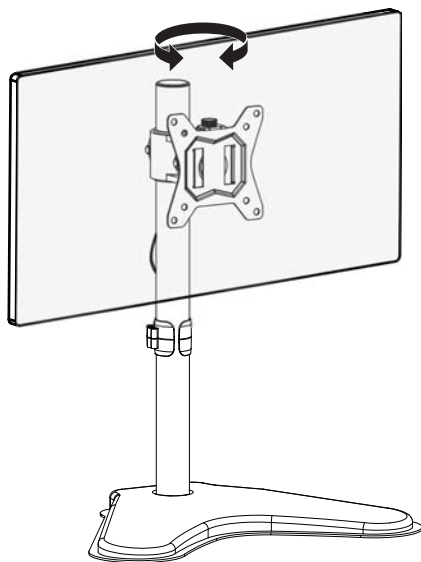

Alcance de inclinación: $+15^\circ$ a -15°

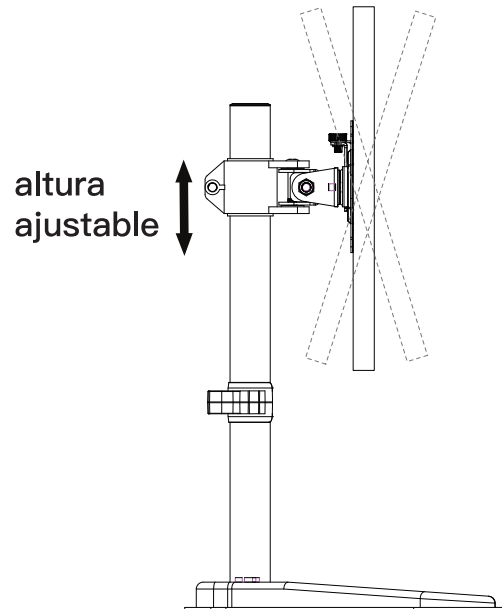

Rango de rotación: $+180^\circ$ a -180°

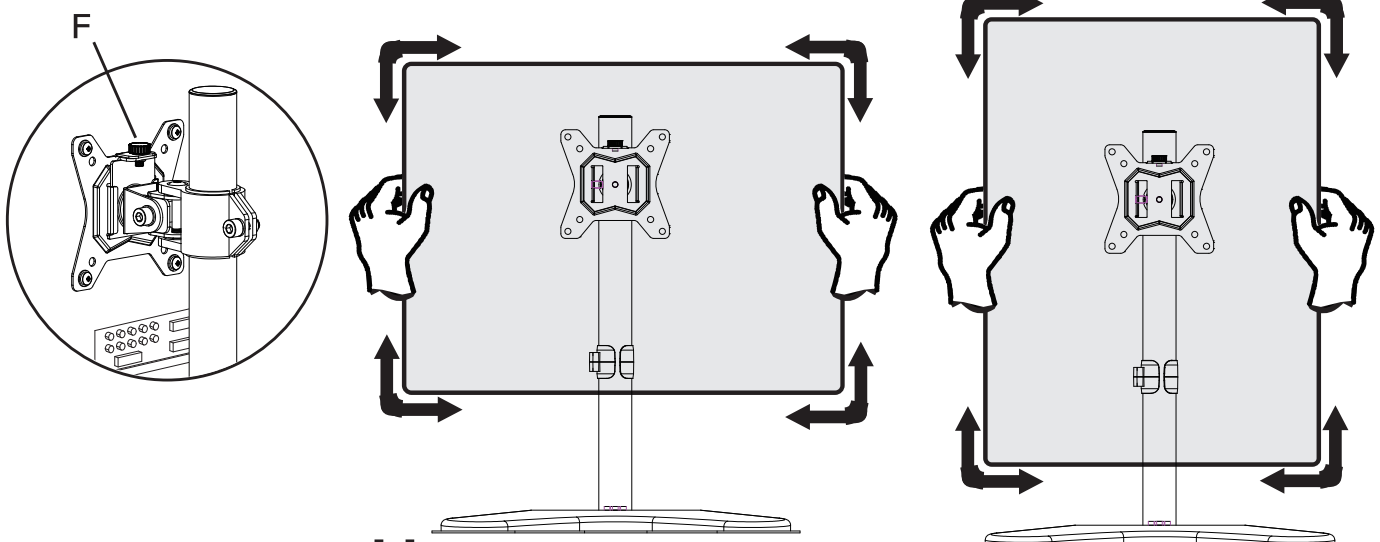

Nota: Apriete el perno [F] antes de girar el monitor



At ErgoAV, we strive to provide the highest value products.
We want to support your purchase.
If you have questions, concerns,
or feedback please let us know!

ErgoAV Customer Care
Phone (877) 419-7832
support@ergoav.com

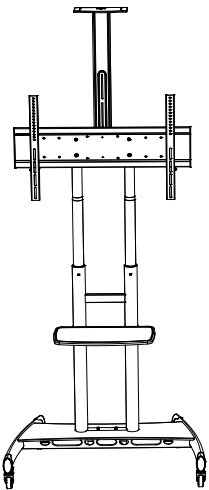

TV Carts

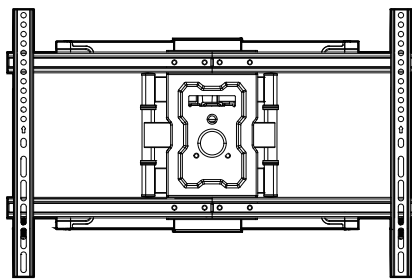

TV Mounts

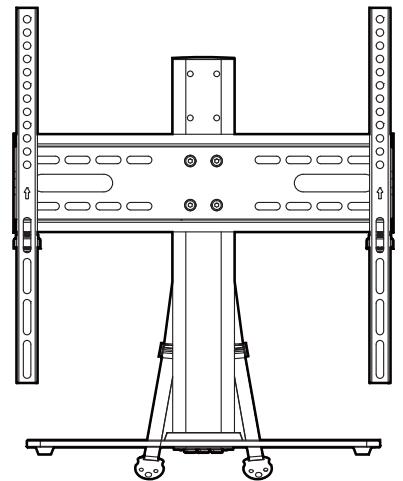

Tabletop TV Stands

9501 Louisiana Ave N, #200, Brooklyn Park, MN 55445
www.ergoav.com