



The ERMML3-01B motion mount fits most TVs 43" to 75" and up to 99 lbs. This mount extends 17.2" from the wall and can be swiveled left or right and tilted, making it possible for you to get optimal viewing in any seating location. Level adjust allows the TV to be properly leveled after installation. Horizontal shift allows TV to be moved horizontally on wall plate to allow optimal placement on wall. This product has been safety tested and UL Certified.

### Features

- Universal Compatibility - Fits most TVs 43-75" with VESA pattern from 200 x 100mm to 600 x 400mm weighing up to 99 lbs.
- Motion Mounts allow the TV to be easily extended away from the wall, swiveled left or right and tilted, making it possible for you to get optimal viewing in any seating location.
- Level adjust allows the TV to be properly leveled after installation.
- Horizontal shift allows TV to be moved horizontally on wall plate to allow optimal placement on wall.
- Easy three step installation. Step-by-step instruction, wall plate template, and universal hardware bag are included in the package.



### TV Compatibility

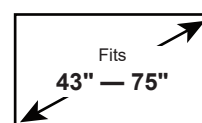
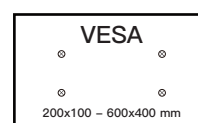

Model Number	ERMML3-01B	WARRANTY:	5-Year
--------------	------------	-----------	--------

Product Specifications	DIMENSIONS (W x H x D)	PRODUCT WEIGHT	LOAD CAPACITY	FINISH	AVAILABLE COLORS
	25.59" x 16.73" x 17.2"	15.5 lbs.	99 lbs.	Powder Coating	Black
	650mm x 425mm x 437mm	7.03 KG	44 KG		

Package Specifications	PACKAGE SIZE (W x H x D)	PACKAGE WEIGHT	PACKAGE UPC CODE	PACKAGE CONTENTS	UNITS IN PACKAGE
	18.07" x 3.18" x 12.44"	17.3 lbs.	810082200065	Product, Manual, Mounting Template, Parts	1 Unit
	459mm x 81mm x 316mm	7.85 KG			

Master Carton Specifications	PACKAGE SIZE (W x H x D)	PACKAGE WEIGHT	UNITS IN CARTON		
	18.77" x 7.36" x 13.03"	35.7 lbs.			2 Unit
	477mm x 187mm x 331mm	16.2 KG			

Product Dimensions

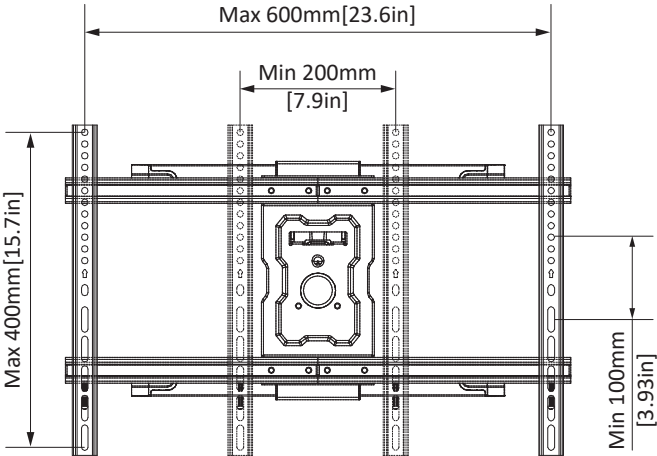

TV INTERFACE

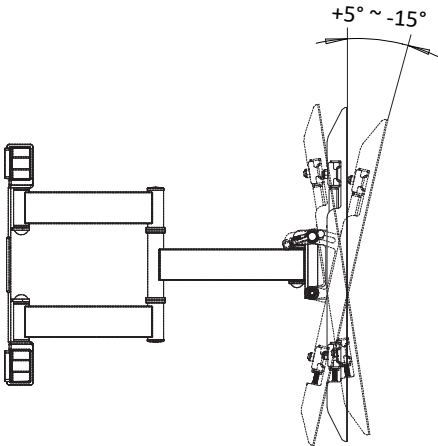

SIDE VIEW - TILTING

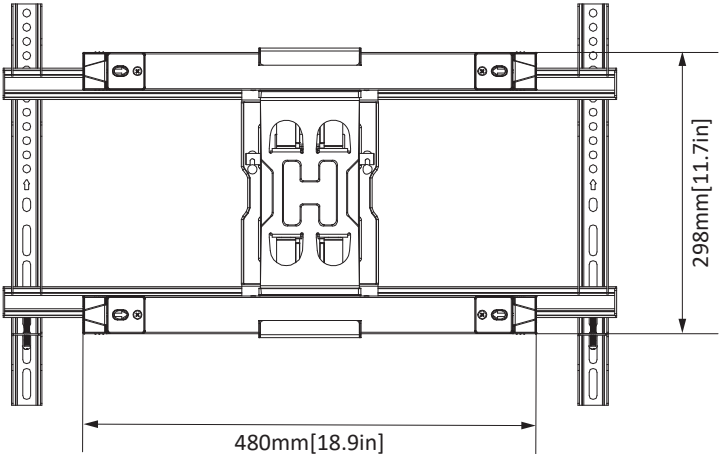

WALL PLATE

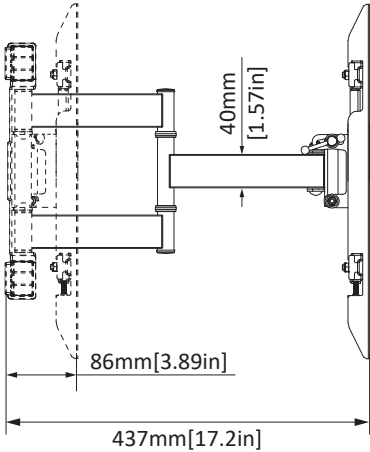

SIDE VIEW