

In-Wall Accessory Box Instruction Manual

Rev00

English 02-17

Français 18 à 33

Español: 64 a 94

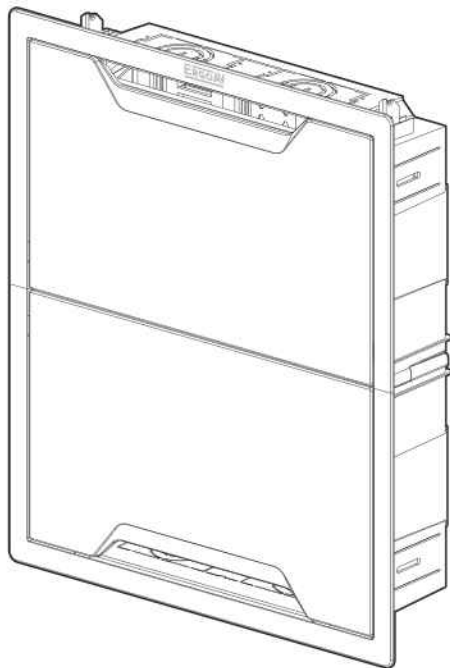

ERIWA4

Thank you for choosing ErgoAV!

At ErgoAV, our goal is to add value to your AV experience by providing the highest quality products and services in the industry. We offer a 5-year warranty. If you have any questions or concerns, please contact us.



ErgoAV



9501 Louisiana Ave N, #200, Brooklyn Park, MN 55445



(877) 419-7832 Mon-Fri 8am - 8pm (CST)



support@ergoav.com



www.ergoav.com

PLEASE READ ALL INFORMATION BEFORE GETTING STARTED

1

Verify Wall
Compatibility

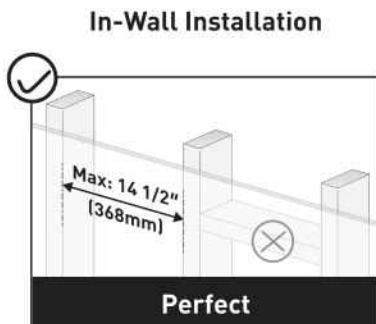

Surface Mount Installation

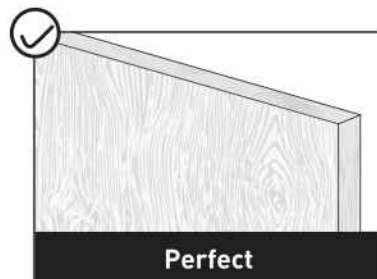

2

Tools Needed
(not included)



Stud Finder



Pencil



Level



Phillips Screwdriver



Knife

3

Important
Safety
Information

1. Do not use this product near water, such as a bath tub, wash bowl, kitchen sink, laundry tub, swimming pool, or in a wet basement.
2. Never push objects of any kind into this product through openings, as they may touch dangerous voltages. Never touch uninsulated telephone wires or terminals, unless the telephone line has been disconnected at the network interface.
3. Never install communications wiring, or components, during a lightning storm.
4. Equipment shall be installed in accordance with ANSI/NFPA 70, National Electrical Code (NEC), NFPA 72, CAN-ULC-S540, Canadian Electrical Code, and/or other applicable sections of ANSI/IEEE C2 & National Electrical Safety Code (NESC). Equipment intended for installation in information technology equipment (computer) rooms should be installed in accordance with NFPA 75, Standard for the Fire Protection of Information Technology Equipment.
5. Power supplied to components must be provided by UL Listed Class 2 power limited power supply.
6. All power limited and non-power limited wiring must be separated by a minimum of 1/4" spacing.
7. Installation shall be completed by a professional electrical contractor or low voltage technician.
8. Maximum load carrying capacity of 30 lb.

Enclosure Physical Installation

Locate enclosure indoors in a low humidity, climate controlled (0°C / 32°F – 49°C / 120°F) area within close proximity to power source. Remove cable knockouts as needed. When required, 2" rubber grommets (AC1034) are available to seal and protect openings. If mounting behind a TV, ensure box is positioned to be concealed from view by the display.

Supplied Parts and Hardware for Step 1

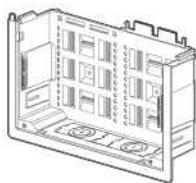

Box Frame Panel

01 x 2



ST3 x 10mm
Screw

A1 x 2

INSTALLATION

STEP 1 Assemble the Box

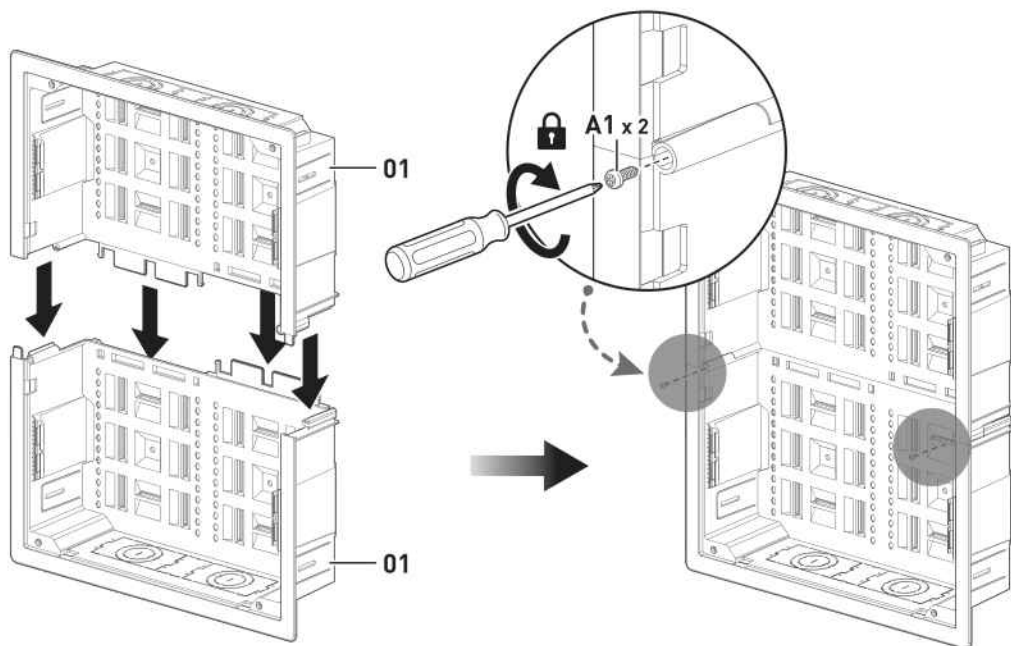

Supplied Parts and Hardware for Step 2



Cutting Template

02 x 1

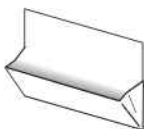

Dust Bag

03 x 1



Drywall Saw

04 x 1



M3 x 45mm
Bolt
A2 x 4

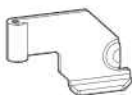

Drywall Clip
A3 x 4



ST4.5 x 10mm
Screw
A4 x 8

STEP 2 Mount the Box on the Wall

For In-Wall Installation, go to Option A on page 04-07.

For Surface Mount Installation, go to Option B on page 08.

Option A

For In-Wall Installation

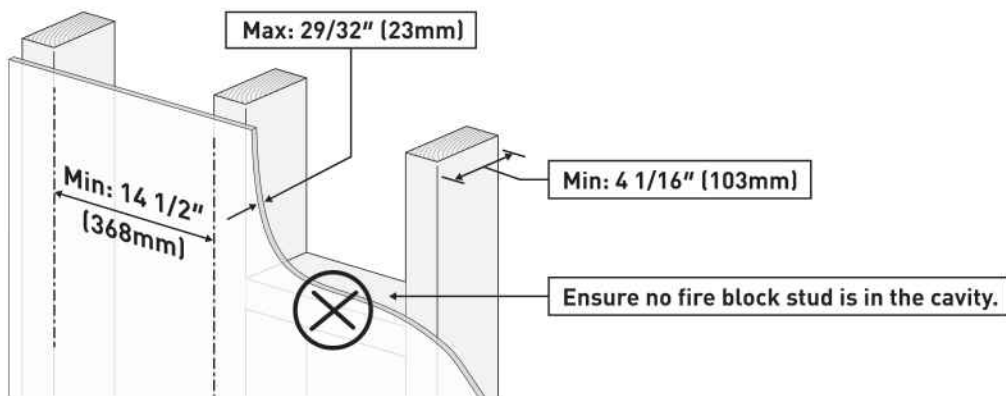

2-1

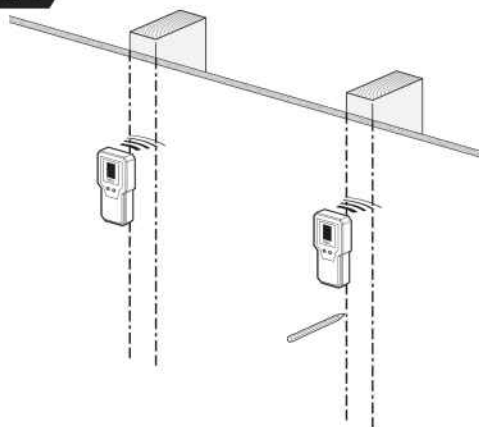

Find Studs

2-2

Locate Position (Between Stud) and Trace the Template

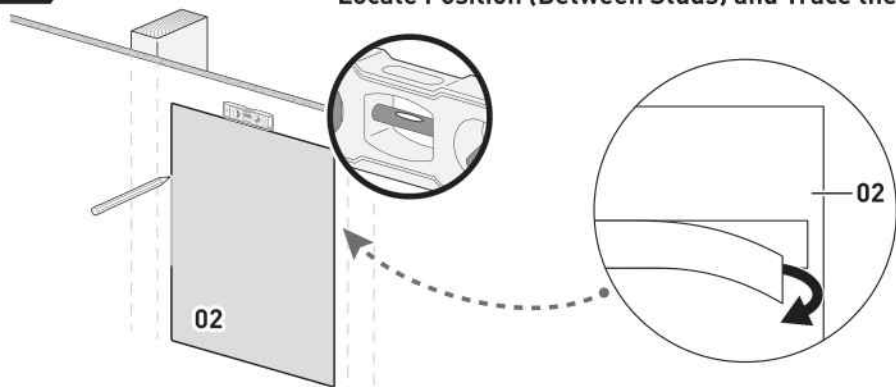

2-3

Cut the Hole

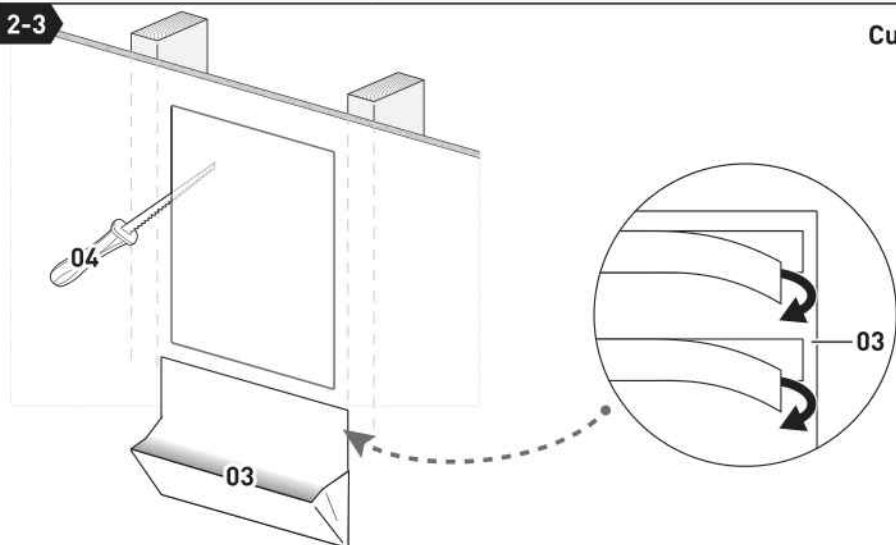

2-4

Install Drywall Clips

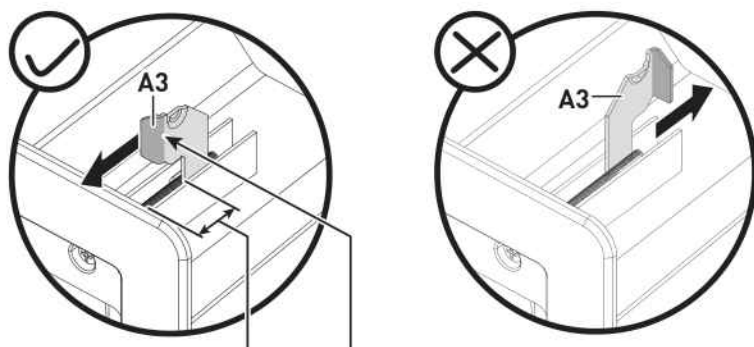

Important: To leave enough space for the drywall, only tighten the clip partially.
Important: Flat part of the clip must face forward.

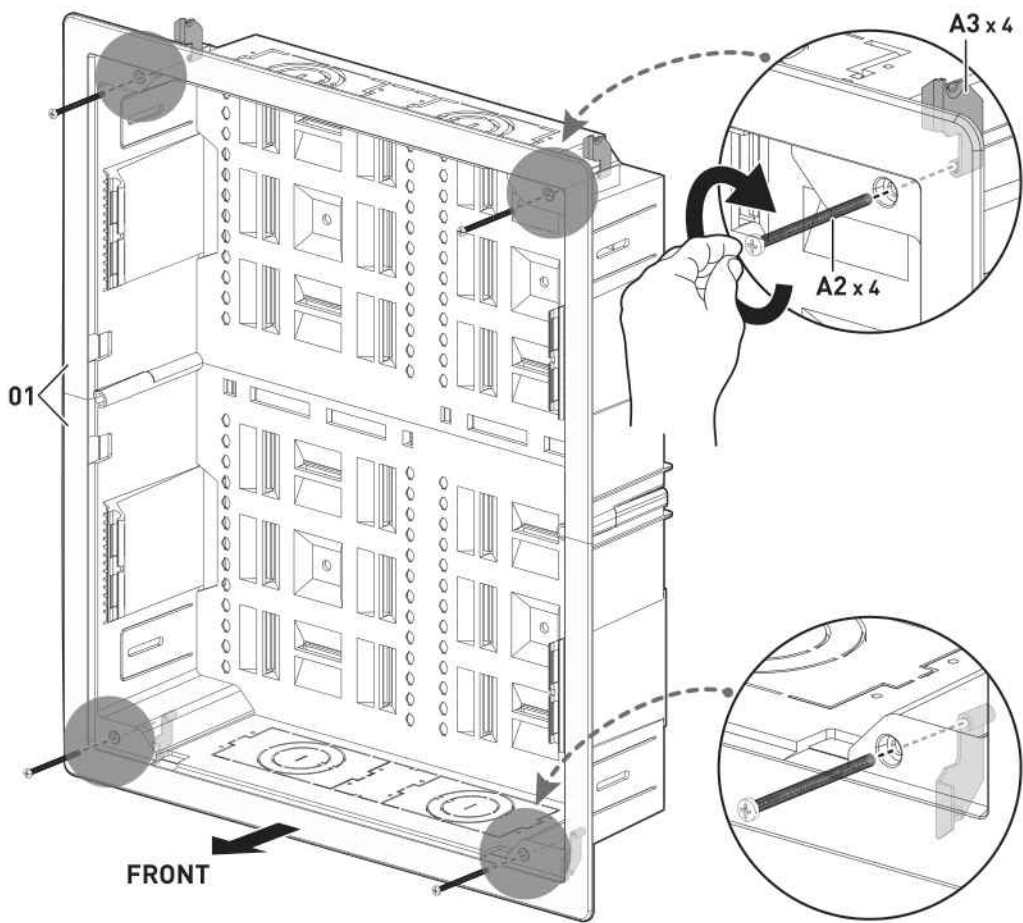

Before Inserting

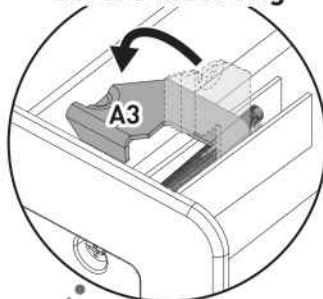

After Inserting

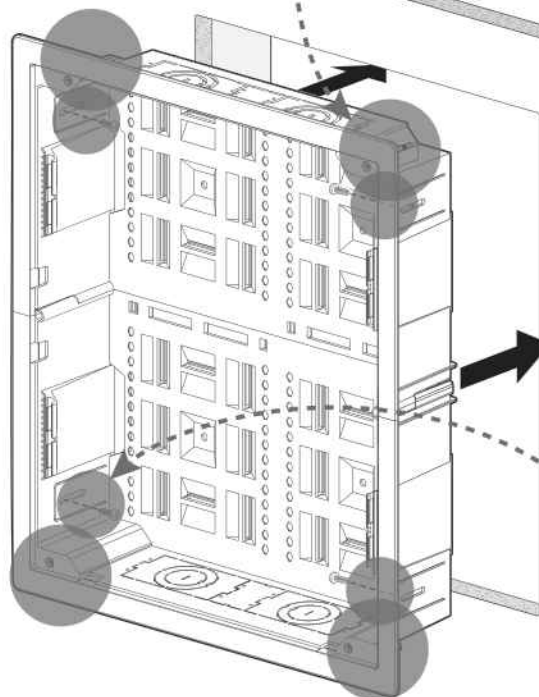
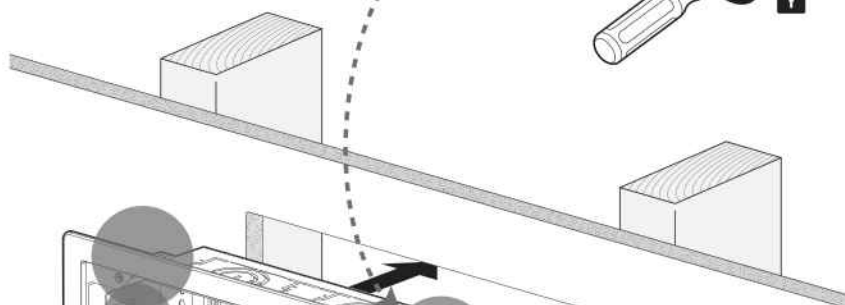
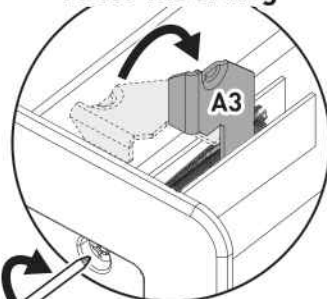

If needed

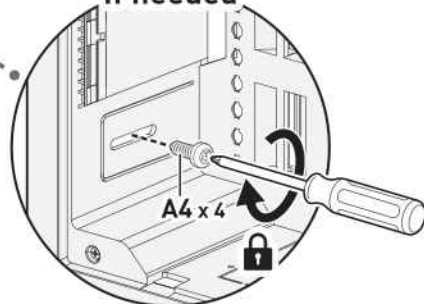

Option B

For Surface Mount Installation

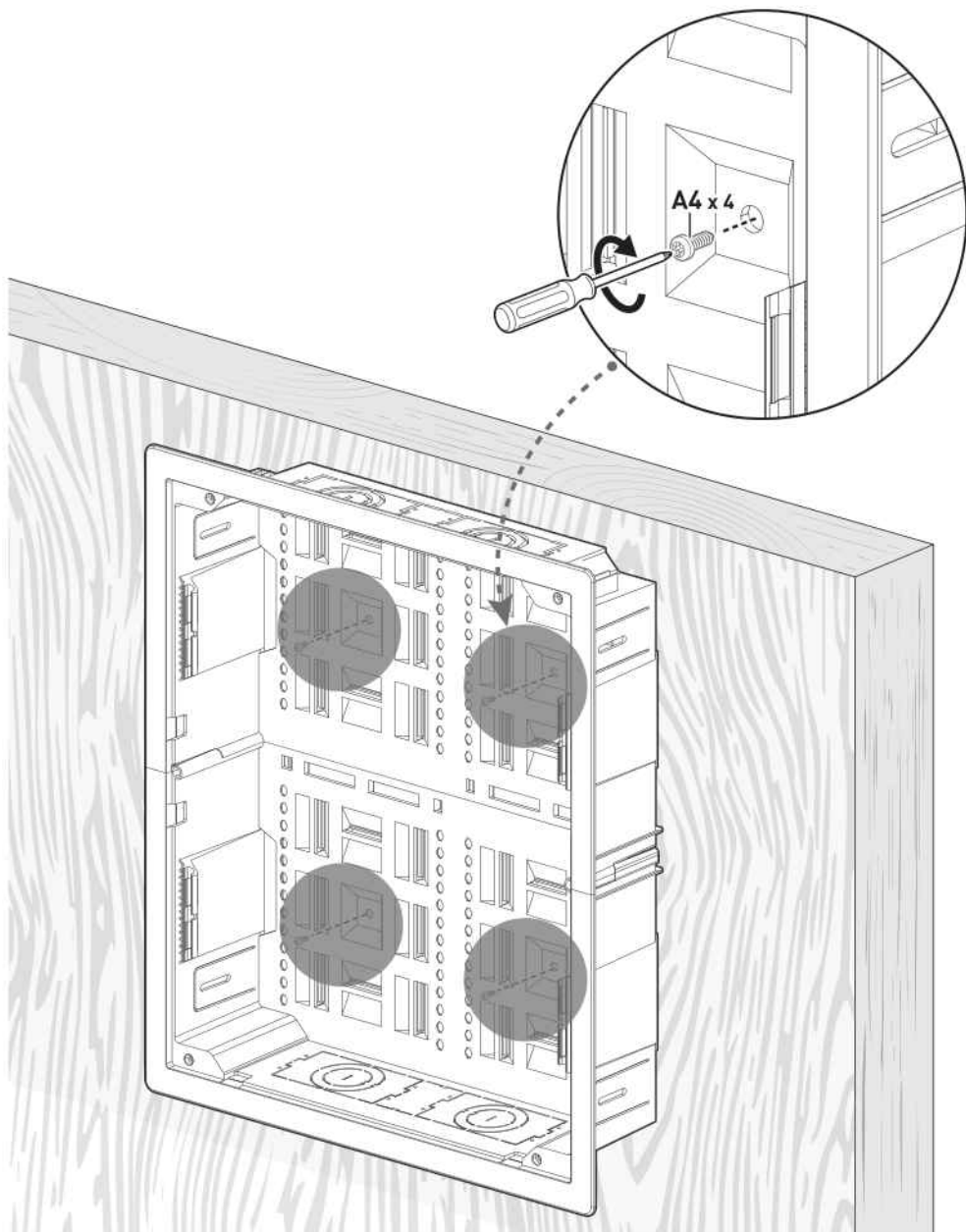

STEP 3 Install a Power Outlet

Remove desired outlet knockout. Install a single-gang metal outlet box. Connect 15 amp, 120 volt power receptacle to power cable with approved wiring method for local codes.

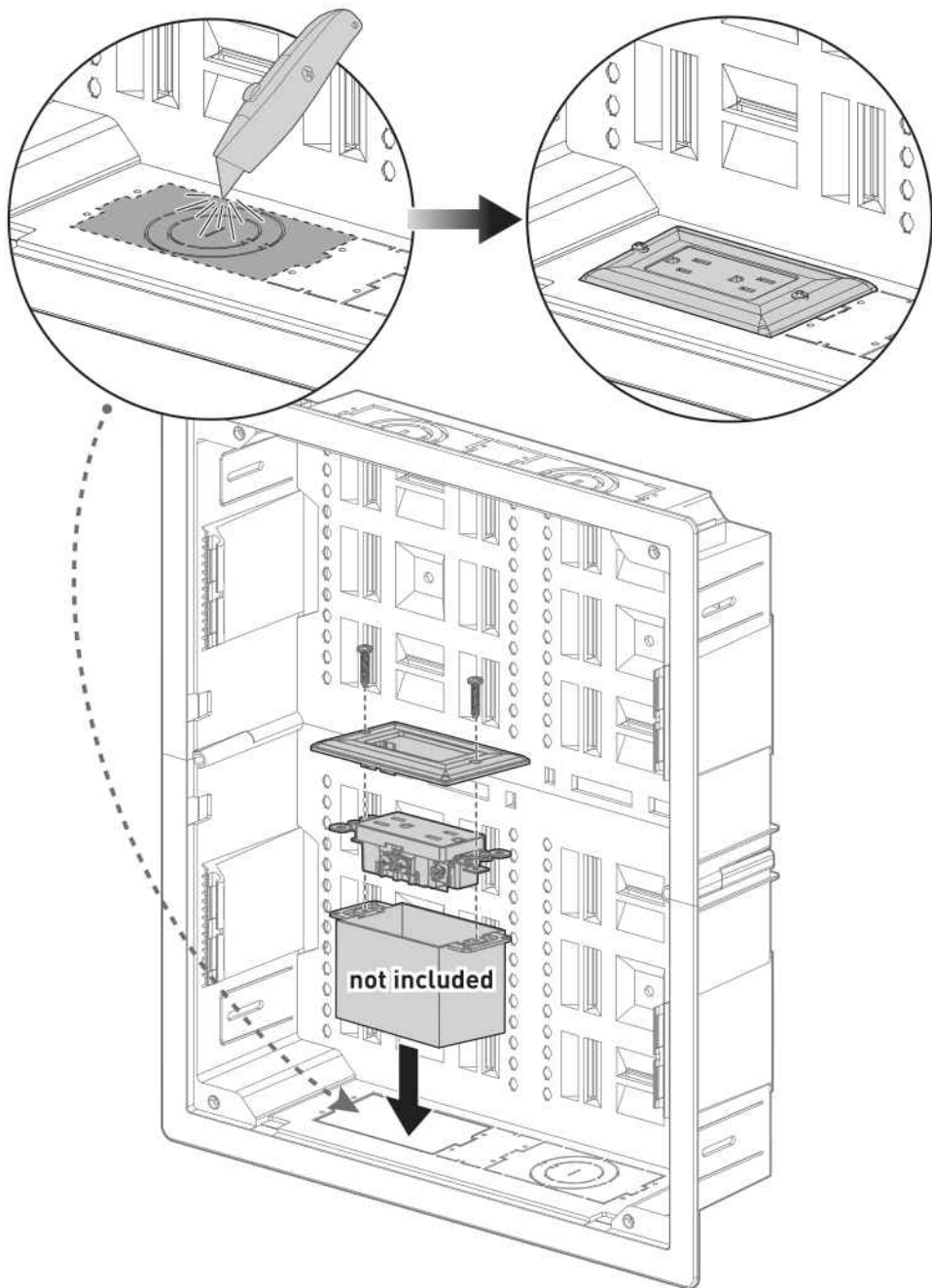

Supplied Parts and Hardware for Step 4

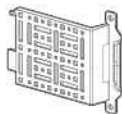

Bracket Panel
05 x 2



Grommet
A5 x 4



Plunger
A6 x 4

STEP 4 Mount Equipment Inside the Box

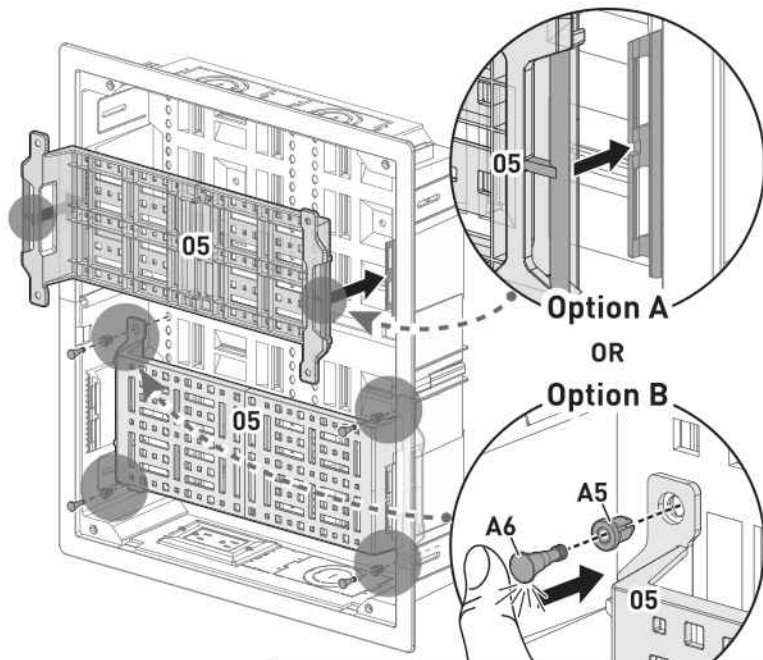
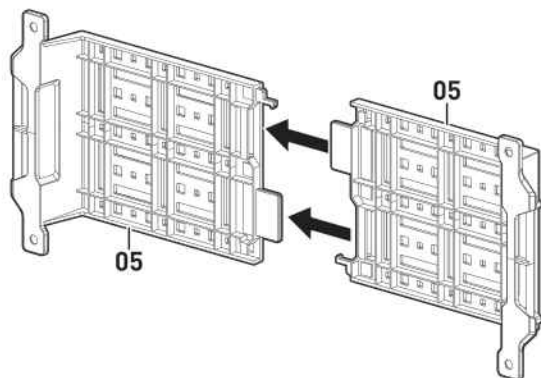

Note: Press firmly until you hear the second click.

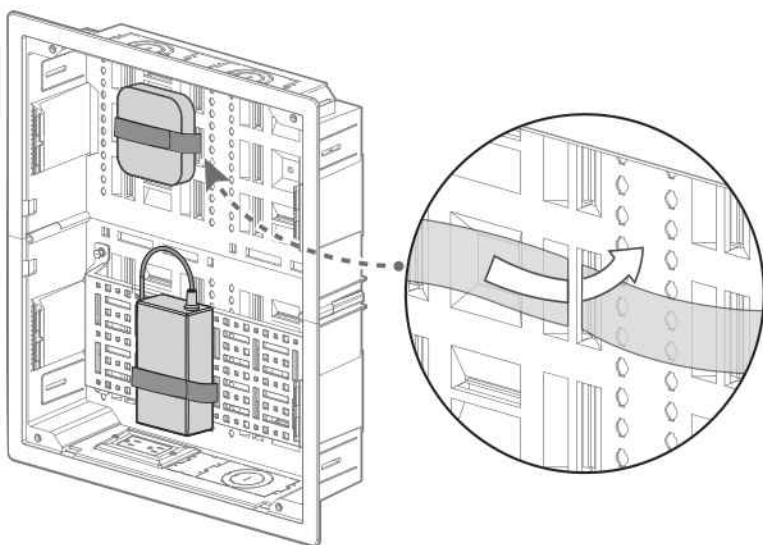

Supplied Parts and Hardware for Step 5



Cover
06 x 2

STEP 5 Install the Box Cover

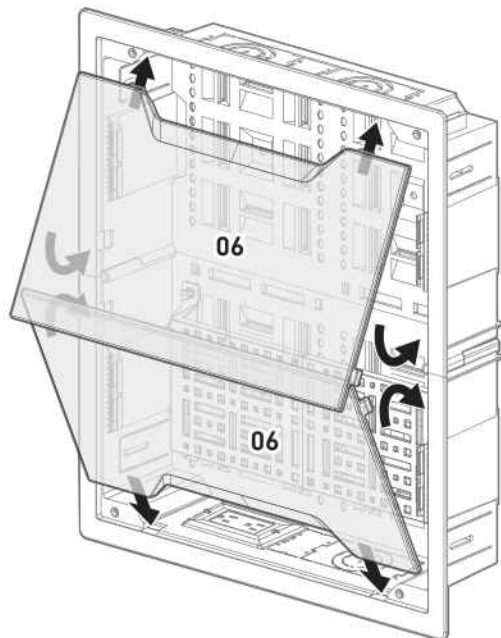

VEUILLEZ LIRE TOUTE L'INFORMATION AVANT DE COMMENCER LA FORMATION

1

Installation dans le Mur

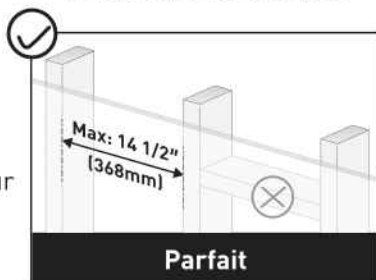

Vérifier
Compatibilité Mur

Parfait

Installation de Support de Surface

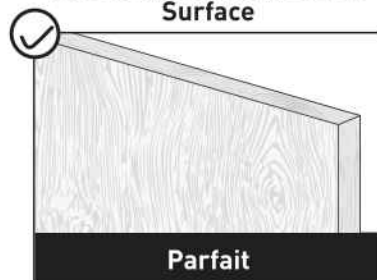

Parfait

2

Outils
nécessaires
(non compris)



Détecteur de
montants



Crayon



Niveau



Tournevis phillips



Couteau

3

Informations
de sécurité
importantes

1. Ne pas utiliser ce produit près de l'eau, tel qu'une baignoire, un bol à laver, un évier de cuisine, un bac à linge, une piscine, ou dans une base humide.
2. Ne jamais pousser des objets de quelque nature que ce soit dans ce produit à travers des ouvertures, car ils pourraient toucher des tensions dangereuses. Ne touchez jamais les câbles téléphoniques non isolés ou les terminaux, sauf si la ligne téléphonique a été déconnectée à l'interface réseau.
3. Ne jamais procéder à l'installation de câblage de communications ou de composants pendant un orage léger.
4. L'équipement doit faire l'objet d'une installation en accord avec ANSI/NFPA 70, National Electrical Code (NEC), NFPA 72, CAN-ULC-S540, Canadian Electrical Code, et/ou d'autres sections applicables de ANSI/IEEE C2 & National Electrical Safety Code (NESC). L'équipement destiné à l'installation dans les salles d'informatique (ordinateurs) devrait être installé en accord avec NFPA 75, Standard pour la Protection contre le Feu des Équipements d'Informatique.
5. L'énergie fournie aux composants doit être fournie par une alimentation électrique limitée de classe 2 répertoriée UL." where the term "power supply" is translated to "alimentation électrique", the term "component" is translated to "composant", and the term "provide" is translated to "fournir".
6. Tous les câblages à alimentation limitée et non limitée en alimentation doivent être séparés par un espace minimum de 1/4" .
7. L'installation doit être réalisée par un entrepreneur en électricité professionnel ou un technicien basse tension.
8. Capacité de charge maximale de capuchon de 30 lb.

Installation physique de l'enceinte :

Localiser l'enceinte à l'intérieur dans une zone à faible humidité, avec un climat contrôlé (0°C / 32°F - 49°C / 120°F), à proximité fermée de la source d'alimentation. Enlever les presse-étoupes pour câbles si nécessaire. Si nécessaire, des oeillets en gommage de 2" (AC1034) sont disponibles pour joint et protéger les ouvertures. Si vous effectuez le support derrière une TV, assurer que la boîte est positionnée pour être dissimulée de la vue par l'écran.

Pièces et matériel fournis pour Étape 1

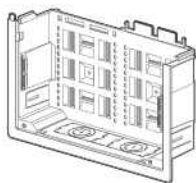

Boîte Cadre Panneau

01 x 2



Vis ST3 x 10mm

A1 x 2

ÉTAPE 1 Assemblage de la Boîte

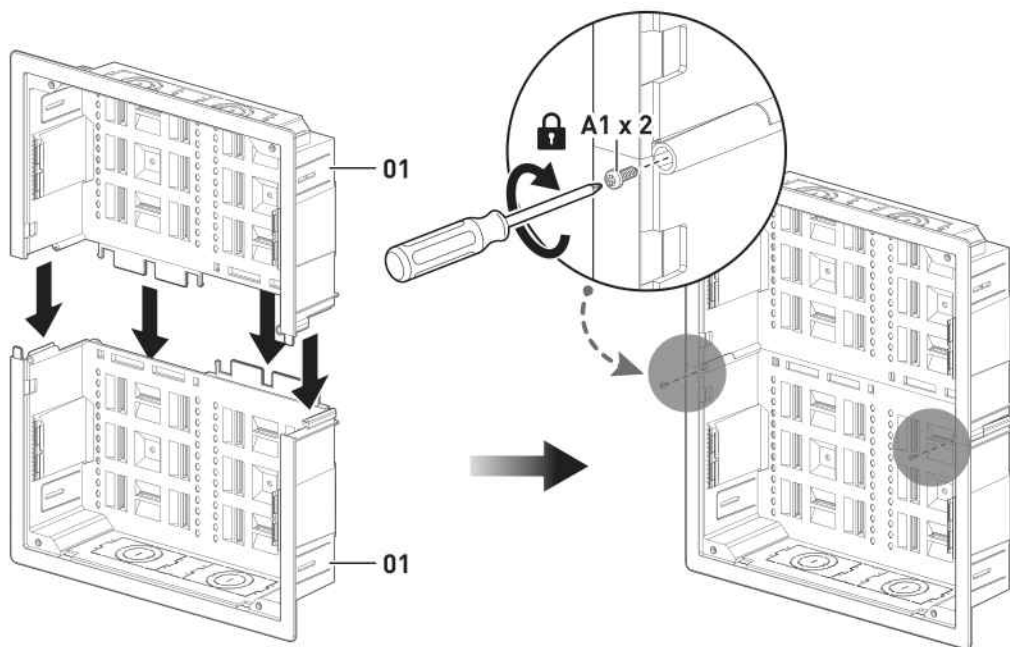

Pièces et matériel fournis pour Étape 2

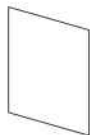

Couper Template

02 x 1

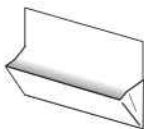

Sac à Dépoussiérer

03 x 1



Scie à Placoplâtre

04 x 1



M3 x 45mm
Boulon
A2 x 4

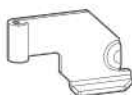

Clip pour Placoplâtre
A3 x 4



ST4.5 x 10mm
Vis
A4 x 8

ÉTAPE 2 Support the Boîte on the Mur

Pour l'Installation En-Mur, allez à l'Option A à la page 14-17.

Pour l' Installation en Surface par Support, allez à l' Option B à la page 18.

Option A

Pour Installation Dans le Mur

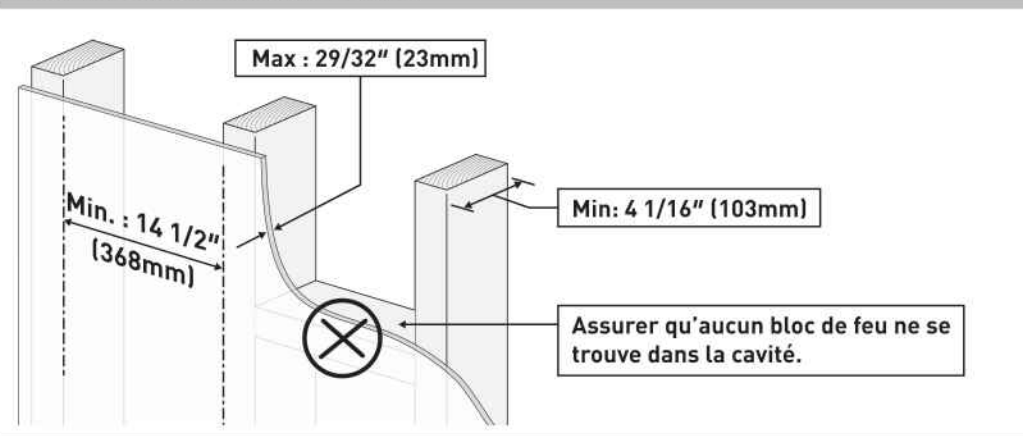

2-1

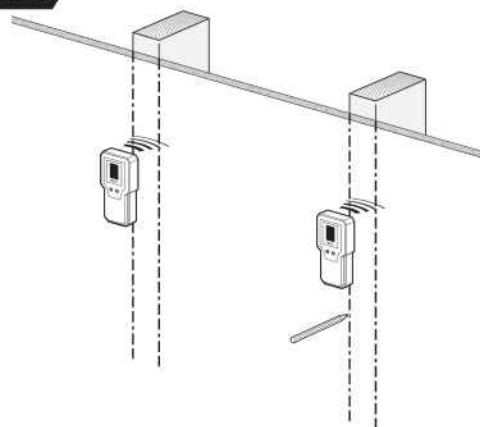

Trouver Studs

2-2

Localiser Position (Entre les montants) et Tracer le gabarit

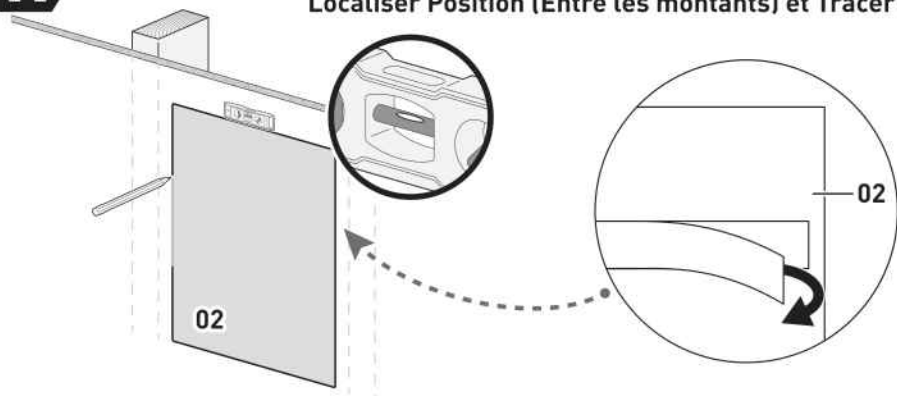

2-3

Couper le Trou

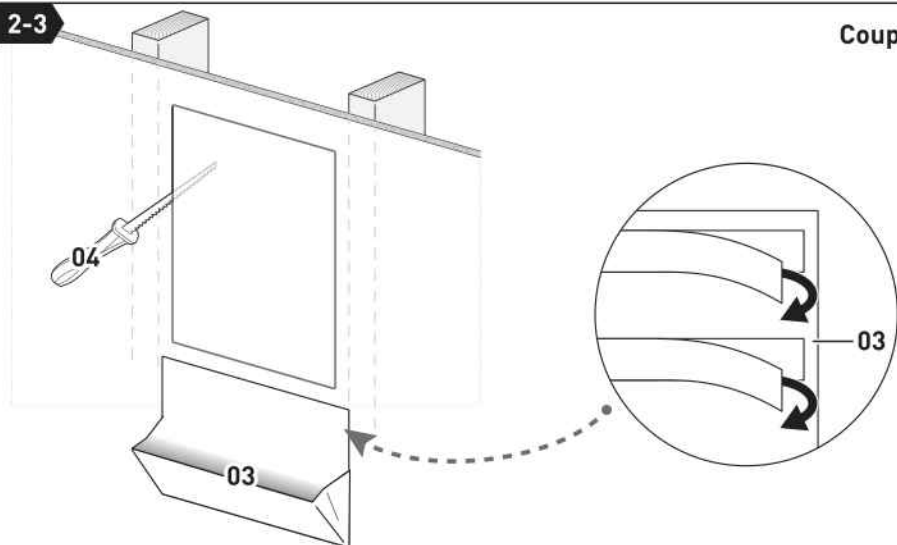

2-4

Installation des Clips de Placoplâtre

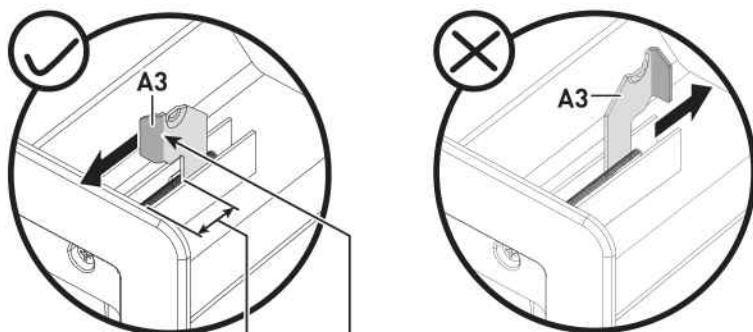

Important : Pour laisser assez d'espace pour le placoplâtre, ne serrer la partie du clip que partiellement.

Important : La partie plate du clip doit faire face avant.

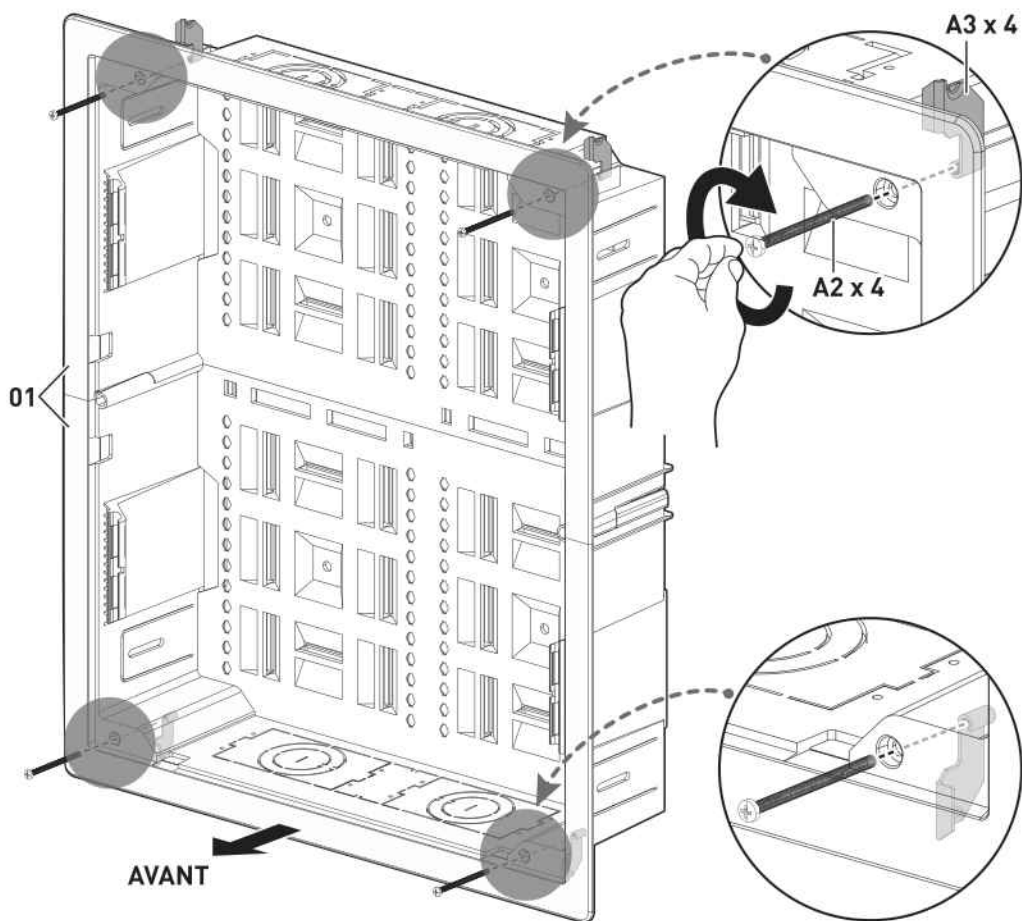

Avant d'insérer

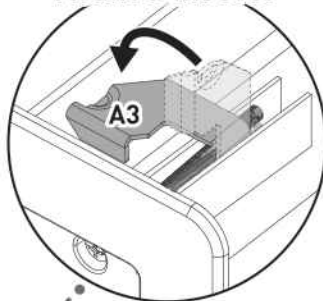

Après Insérer

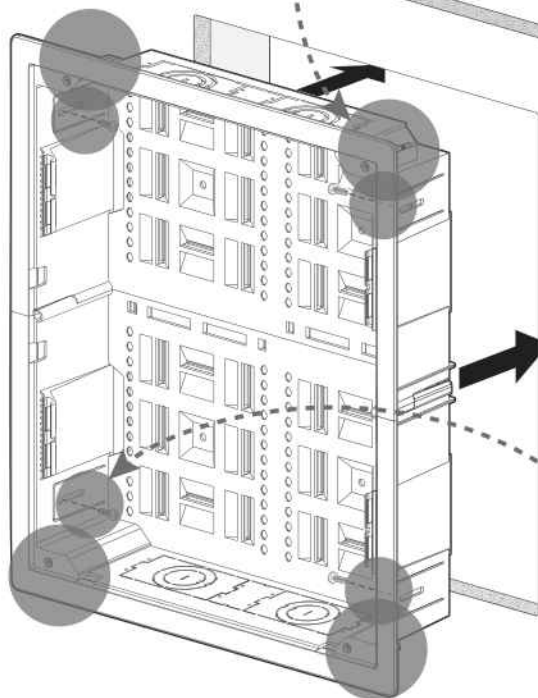
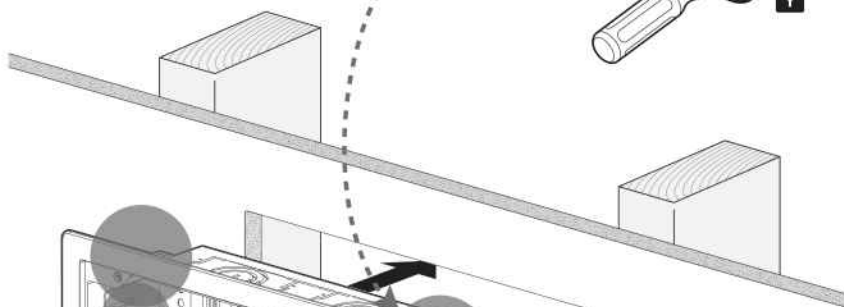
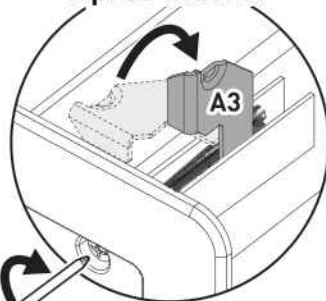

Si nécessaire

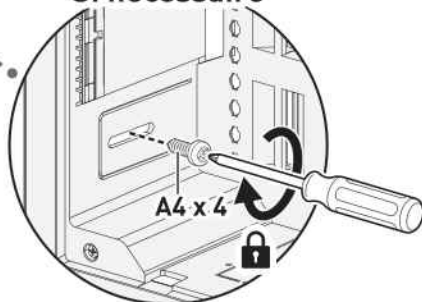

Option B

Pour Installation En Surface Avec Support

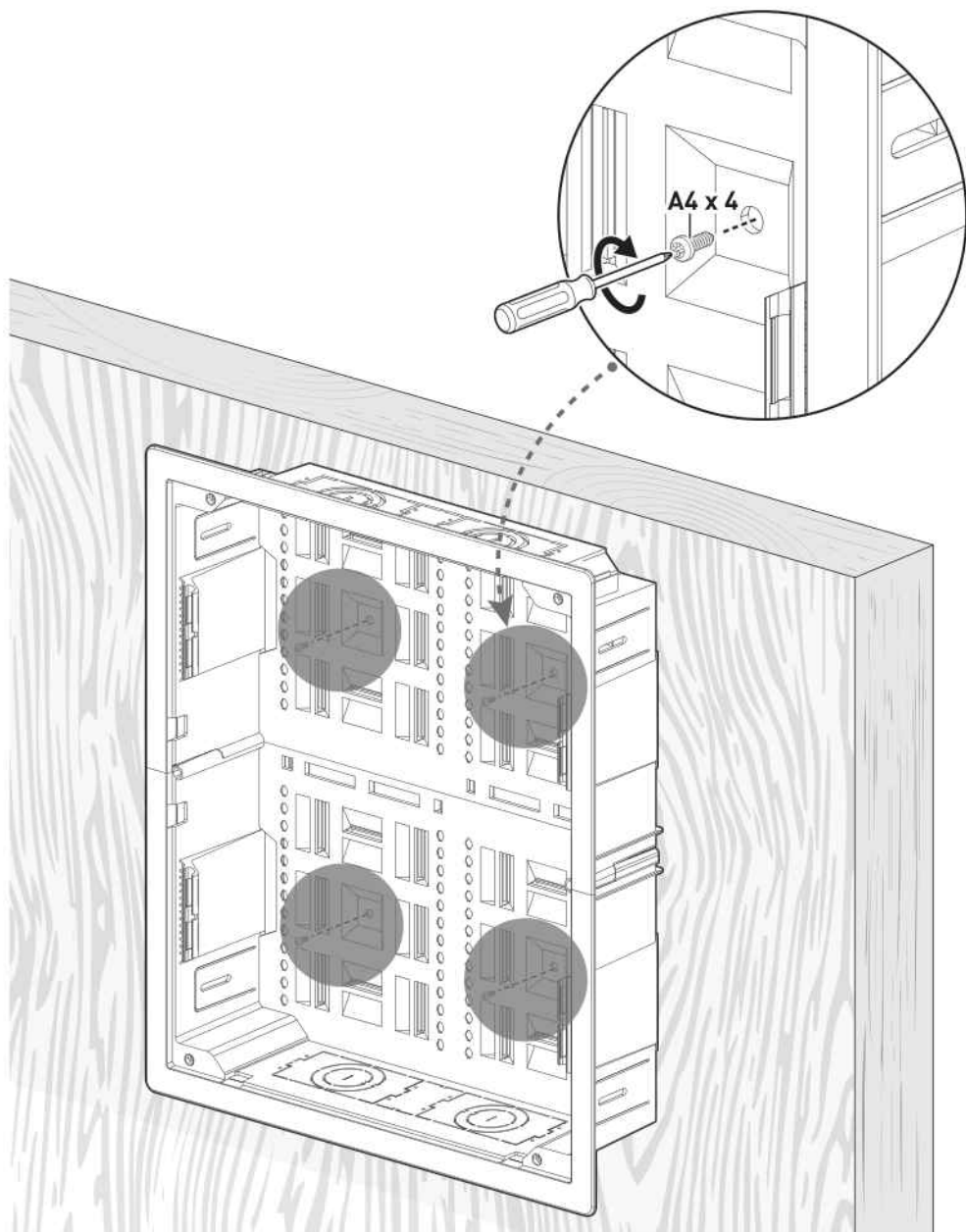

ÉTAPE 3 Installation d'une Sortie d'énergie

Enlever la découpe de prise de courant souhaitée. Installation d'une boîte métallique simple pour prise de courant. Connecter une prise de courant de 15 amp, 120 volt au câble d'alimentation avec une méthode de câblage approuvée selon les codes locaux.

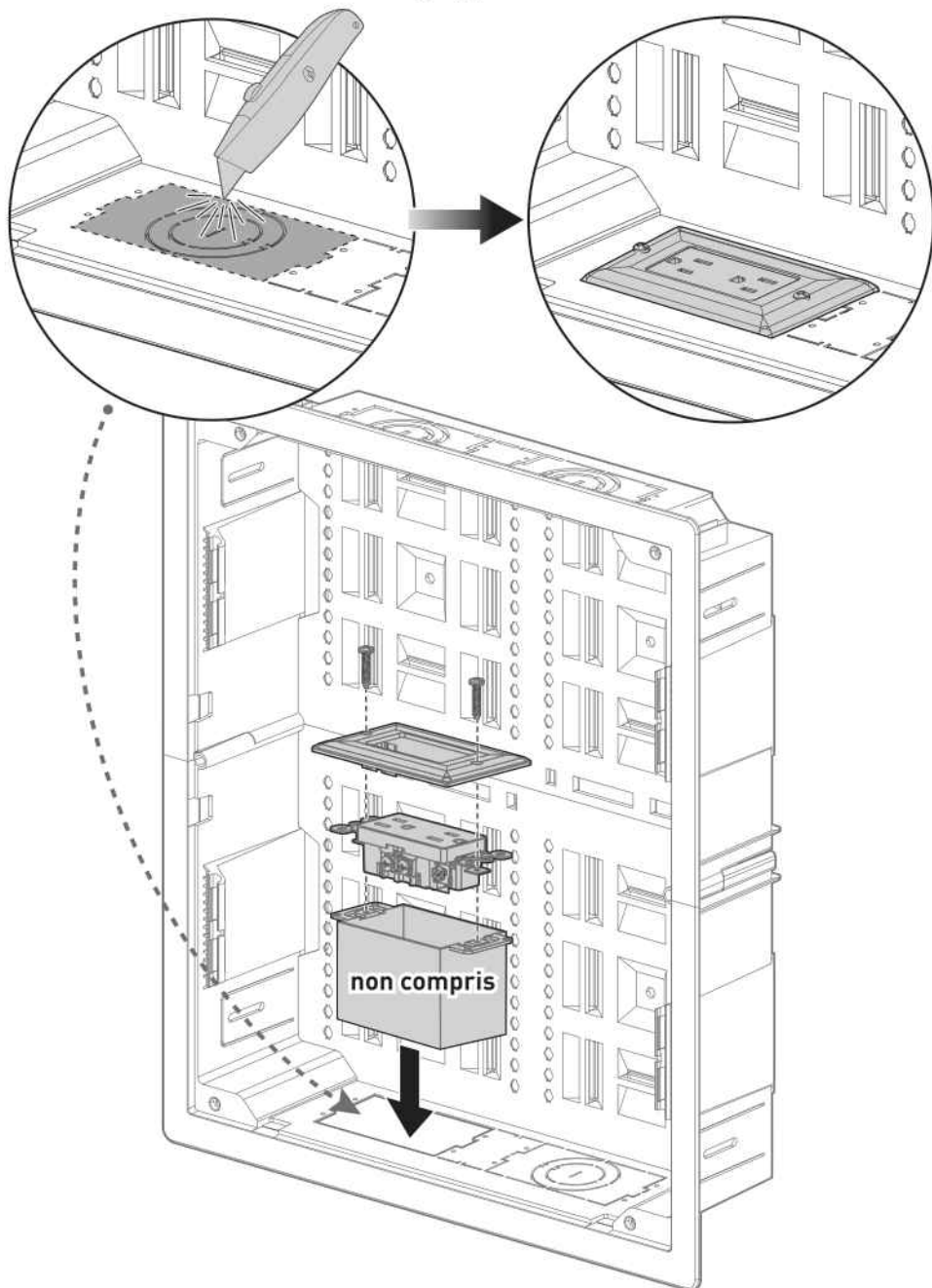

Pièces et matériel fournis pour Étape 4

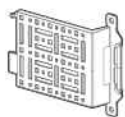

Support Panneau

05 x 2



Oeillet

A5 x 4



Piston de plongeur

A6 x 4

ÉTAPE 4 Support Equipment Inside the Boîte

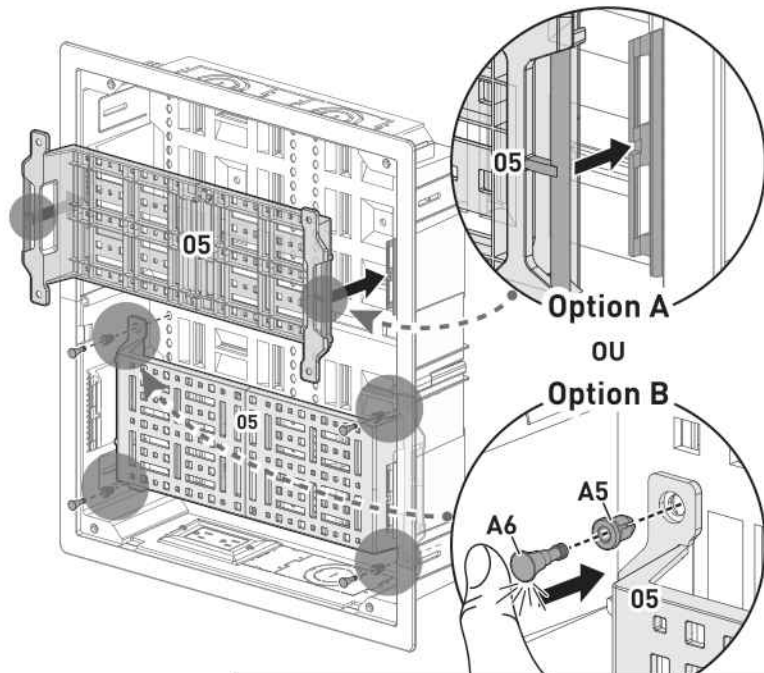
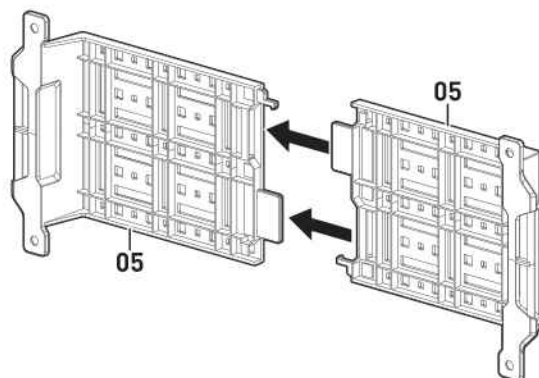

Remarque: Appuyer sur fermeture jusqu'à écouter le deuxième clic.

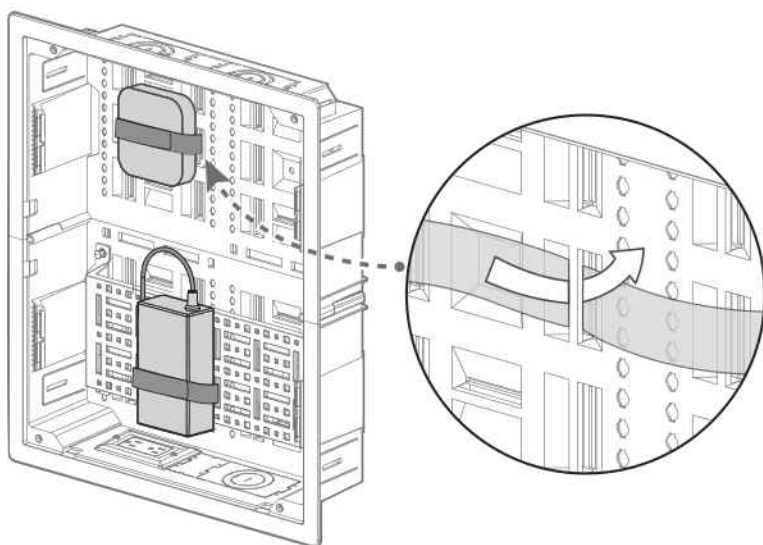

Pièces et matériel fournis pour Étape 5



Housse
06 x 2

ÉTAPE 5 Installation de la Housse de la Boîte

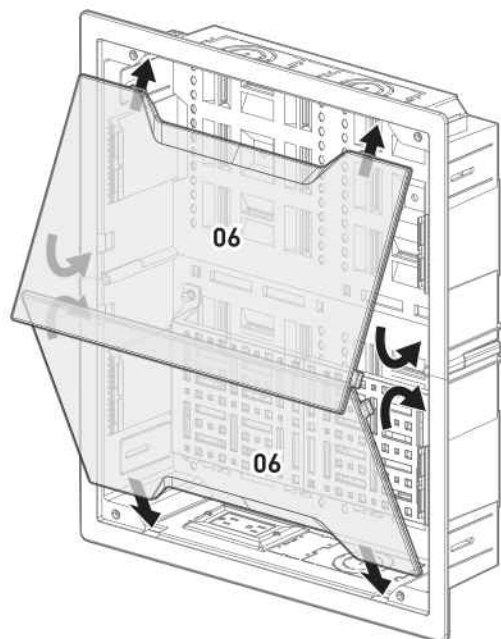

POR FAVOR LEE TODA LA INFORMACIÓN ANTES DE COMENZAR

1

Verificar
Compatibilidad
de Pared



Superficie Montaje Instalación

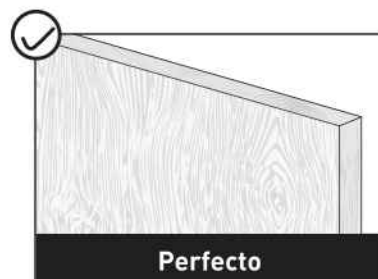

2

Herramientas
necesarias
(no incluido)



Buscador de
montantes



Lápiz



Nivel



Destornillador phillips



Cuchillo

3

Información
de seguridad
importante

1. No use este producto cerca de agua, como en una bañera, palangana, fregadero de cocina, tina de lavar, piscina o en un sótano húmedo.
2. Nunca empujes objetos de cualquier tipo dentro de este producto a través de las aperturas, ya que podrían tocar voltajes peligrosos. Nunca toques alambres de teléfono o terminales sin aislar, a menos que la línea telefónica haya sido desconectada en la interfaz de la red.
3. Nunca realice la instalación de alambrado de comunicaciones, o componentes, durante una tormenta con luz.
4. El equipo debe instalarse de acuerdo con ANSI/NFPA 70, Código Nacional Eléctrico (NEC), NFPA 72, CAN-ULC-S540, Código Eléctrico Canadiense, y/o otras secciones aplicables de ANSI/IEEE C2 & Código Nacional de Seguridad Eléctrica (NESC). El equipo destinado a la instalación en salas de equipos de tecnología informática (computadoras) debe instalarse de acuerdo con NFPA 75, Estándar para la Protección contra el Fuego de Equipos de Tecnología Informática.
5. La potencia suministrada a los componentes debe ser proporcionada por una fuente de alimentación limitada de Clase 2 listada por UL.
6. Todo el alambrado limitado de energía y no limitado de energía debe estar separado por un espacio mínimo de 1/4" .
7. La instalación deberá ser completada por un contratista eléctrico profesional o un técnico de baja tensión.
8. Capacidad máxima de carga de 30 lb.

Instalación Física del Enclosure

Localizar el enclosure en un área interior con baja humedad y control climático (0°C / 32°F - 49°C / 120°F) dentro de un lugar cercano a la fuente de energía. Remover los cable knockouts según sea necesario. When requerir, 2" ojal de frotar (AC1034) están disponibles para sello y protección de aperturas. Si el montaje es detrás de una TV, asegurar que la caja esté en una posición que quede oculta de la vista por la pantalla.

Piezas suministradas y artículos de ferretería para Paso 1

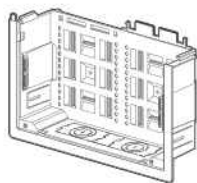

Caja Marco Panel

01 x 2



ST3 x 10mm

Tornillo

A1 x 2

PASO 1 Conjunto la Caja

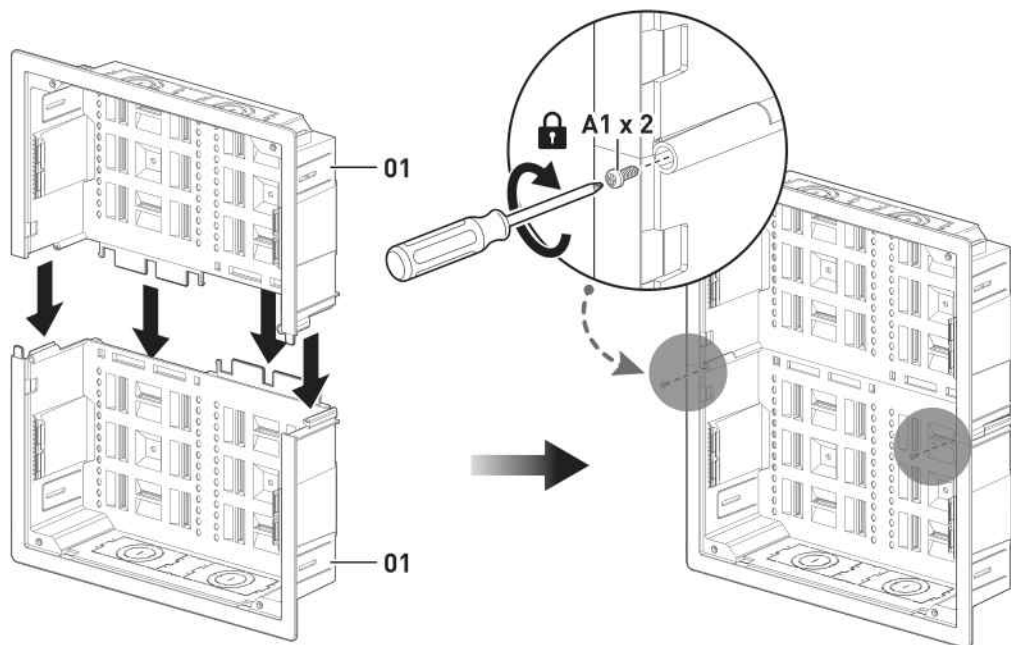

Piezas suministradas y artículos de ferretería para Paso 2

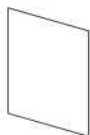

Plantilla de Cortar

02 x 1

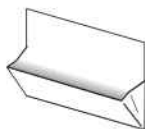

Bolsa de Polvo

03 x 1



Sierra para panel de yeso

04 x 1



M3 x 45mm
Perno
A2 x 4

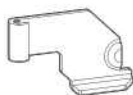

Clip para panel de yeso
A3 x 4



ST4.5 x 10mm
Tornillo
A4 x 8

PASO 2 Montaje de la Caja en la Pared

Para Instalación En-Pared, vaya a la Opción A en la página 24-27.

Para la Instalación de Montaje en Superficie, vaya a la Opción B en la página 28.

Opción A

Para Instalación En-Pared

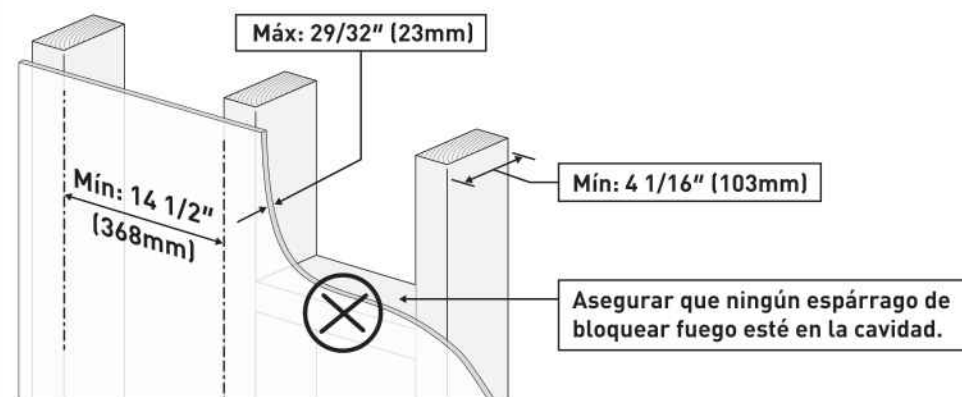

2-1

Encontrar Studs

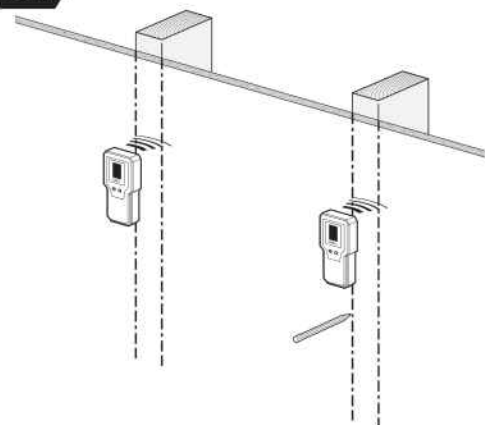

2-2

Localizar Posición (Entre Montantes) y Trazar la Plantilla

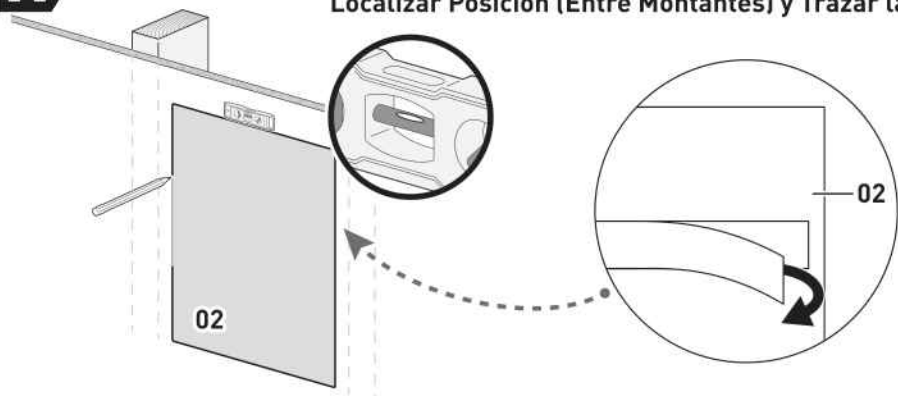

2-3

Cortar el Agujero

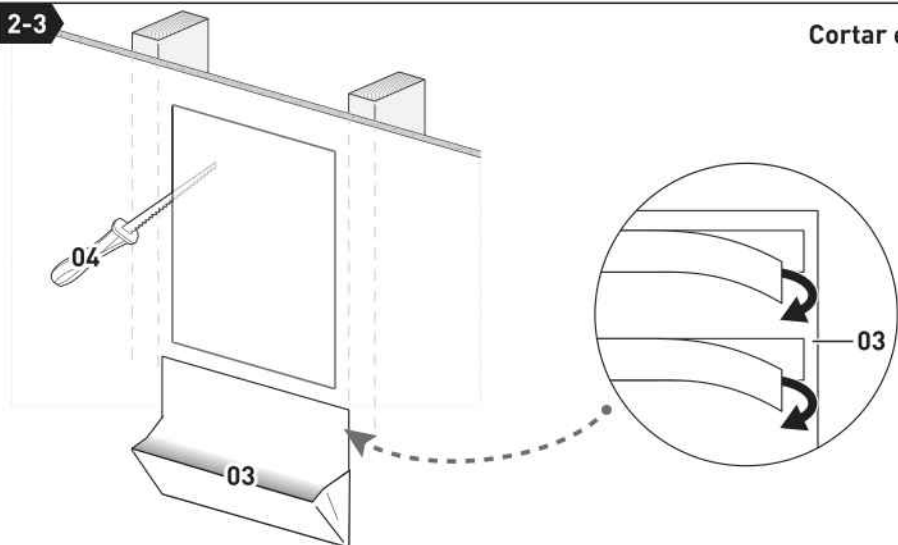

2-4

Instalación de Clips para Panel de Yeso

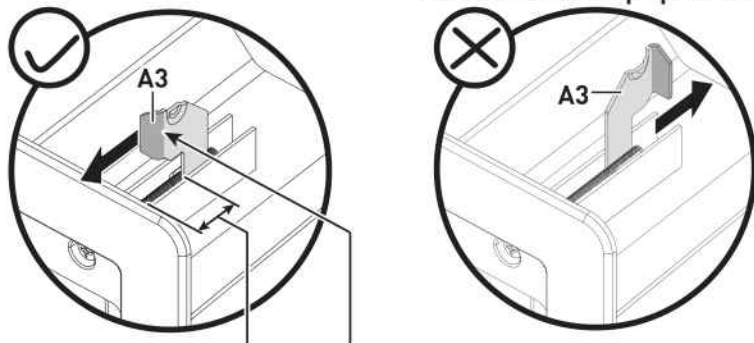

Importante: Para dejar suficiente espacio para el panel de yeso, solo apriete la pieza parcialmente.

Importante: La pieza plana del clip debe vista hacia adelante.

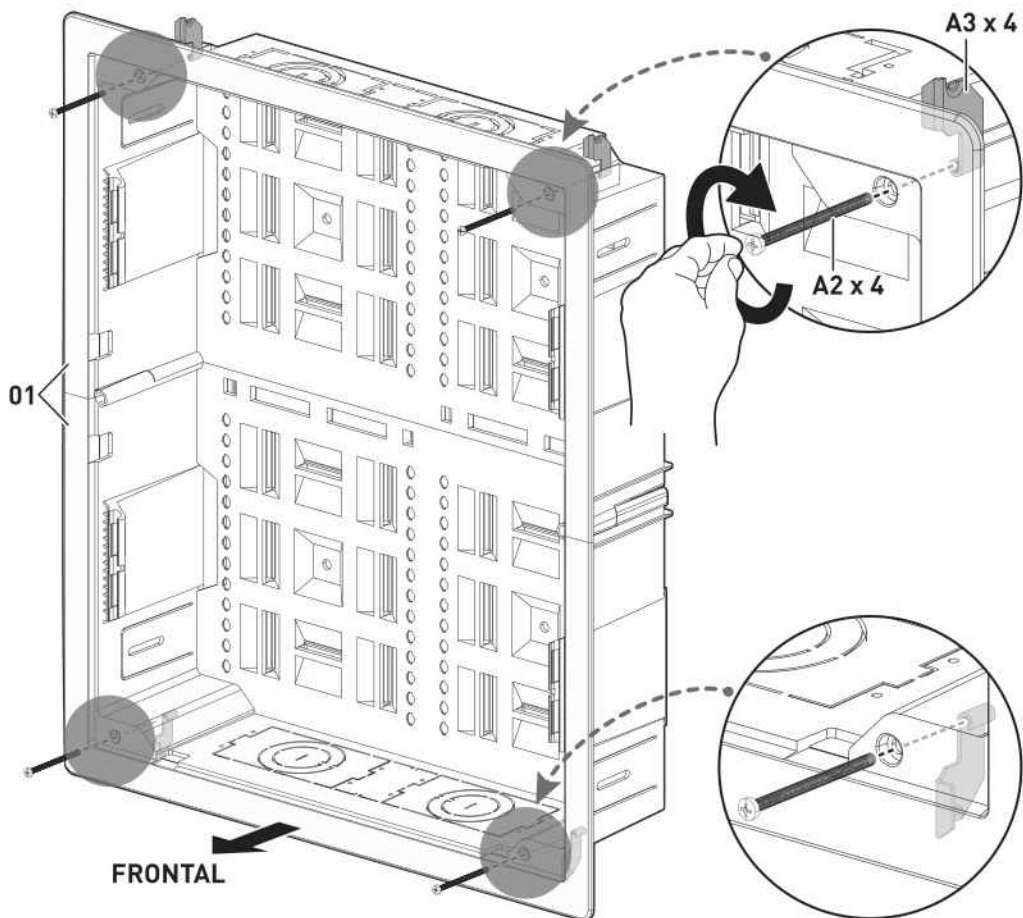

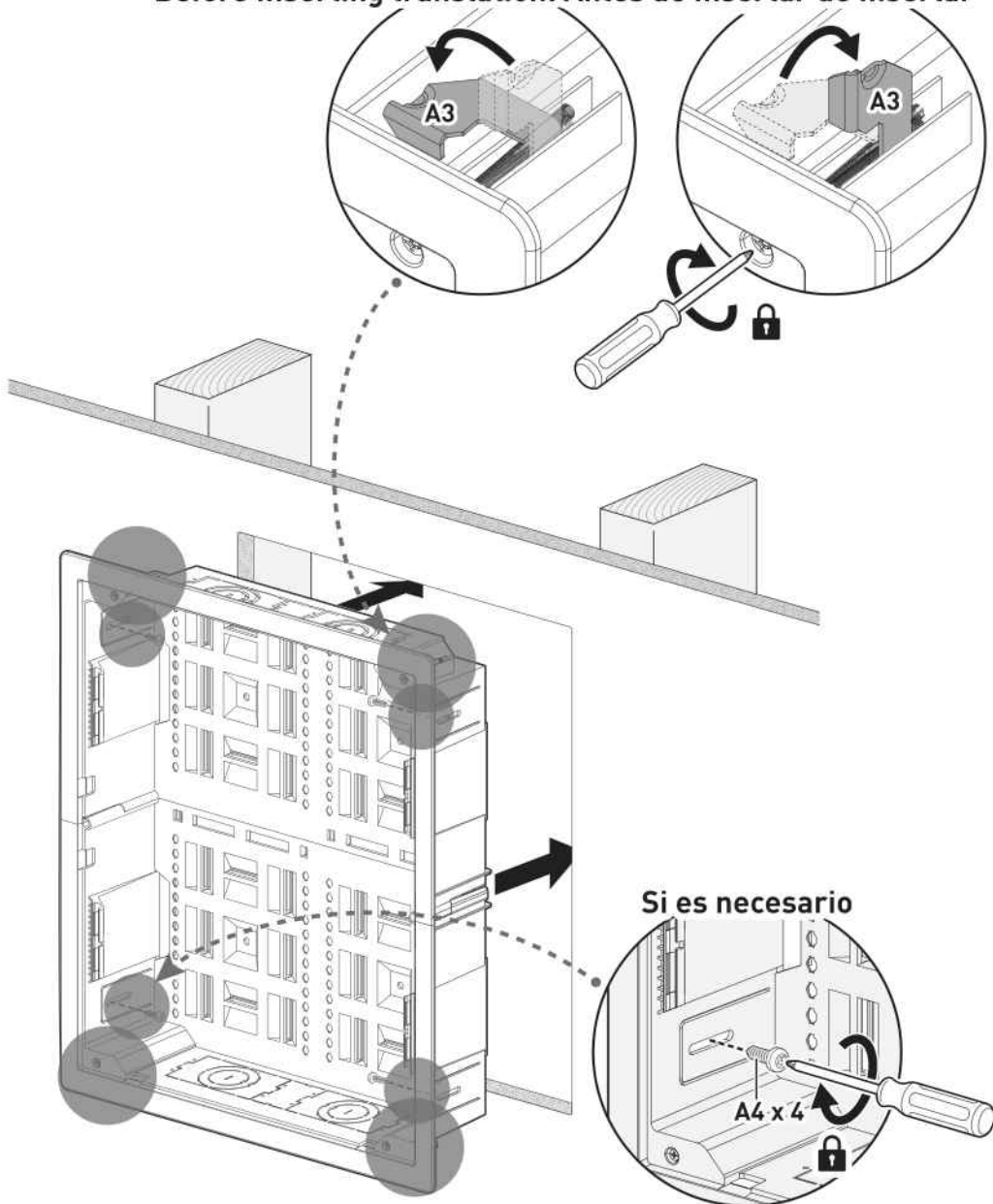
Before Inserting translation: Antes de Insertar de Insertar

Opción B

Para Montaje Superficial Instalación

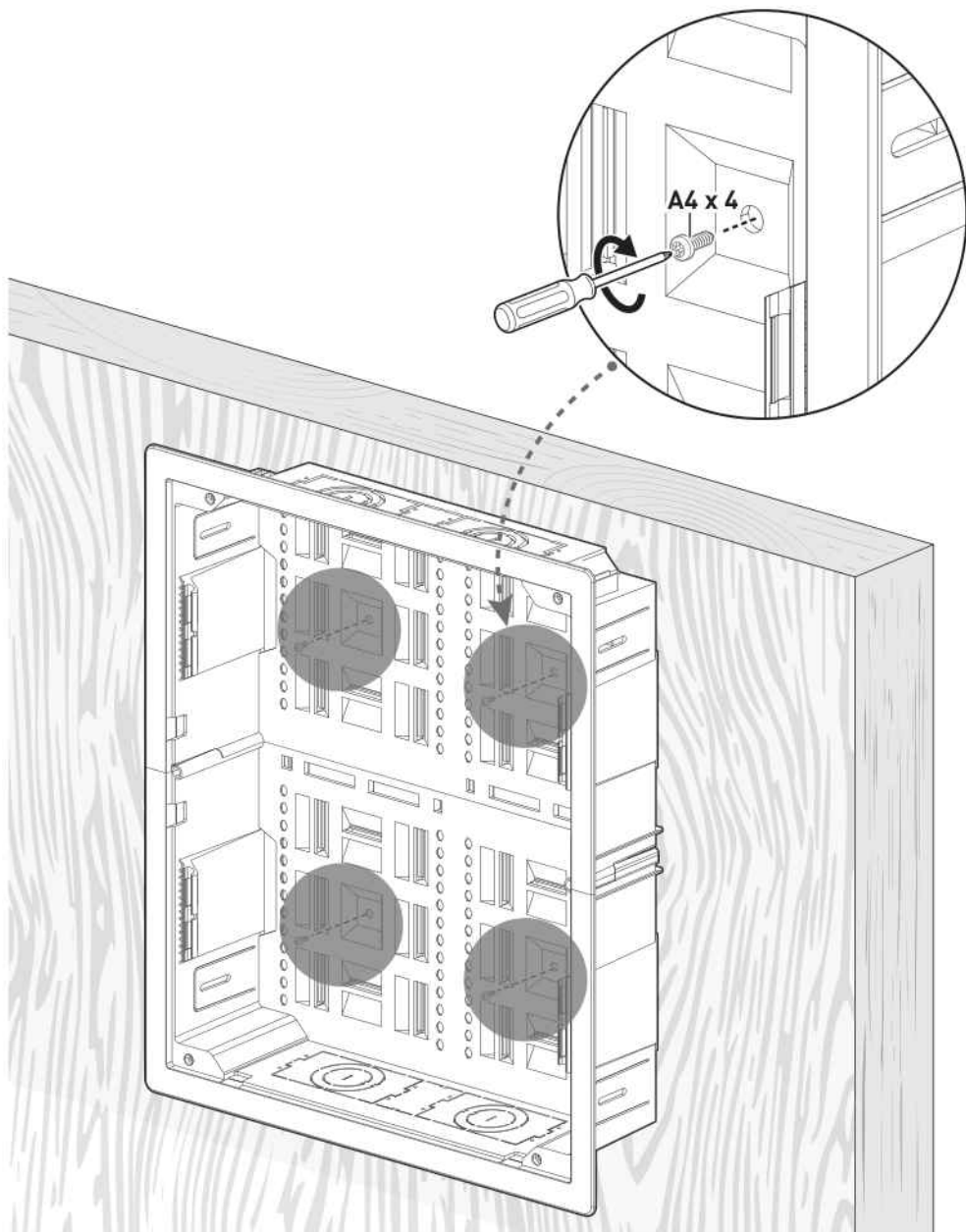

PASO 3 Instalación de una Toma de corriente

Remover la salida de golpeteo deseada. Instalación de una caja de metal de salida de una sola entrada. Conectar el tomacorriente de 15 amperios, 120 voltios al cable de alimentación con método de alambrado aprobado para los códigos locales.

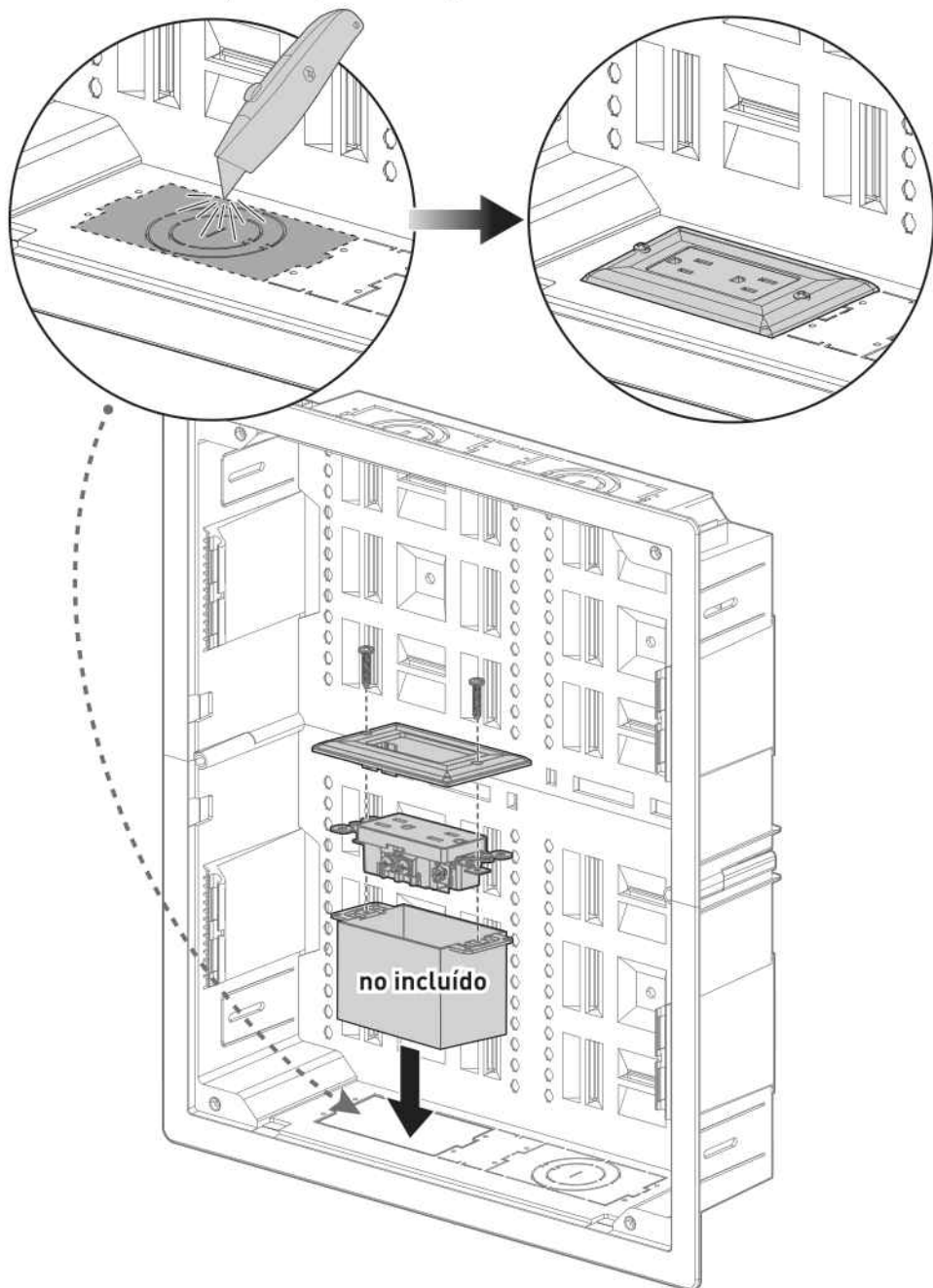

Piezas suministradas y artículos de ferretería para el Paso 4

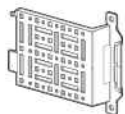

Soporte Panel
05 x 2



Ojal
A5 x 4



Embudo de desatascar
A6 x 4

PASO 4 Monte el equipo dentro de la Caja.

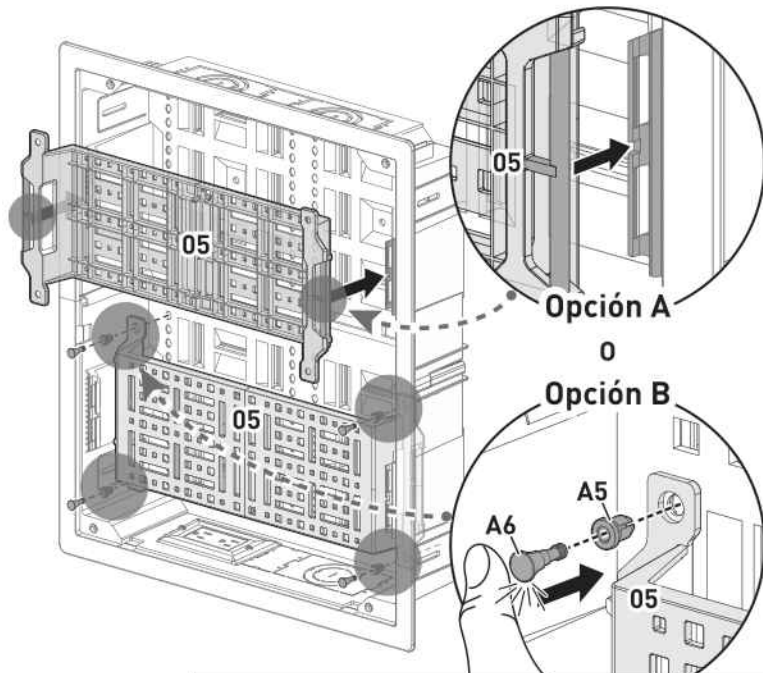
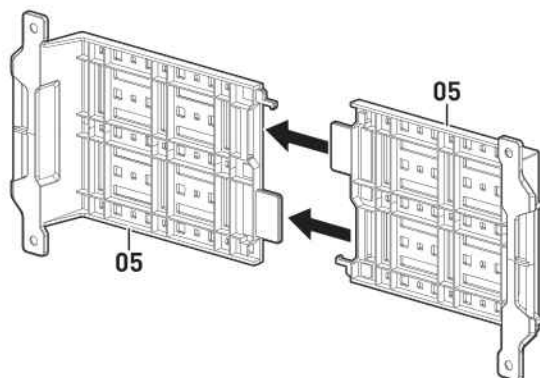

Nota: Prensa firmemente hasta escuchar el segundo clic.

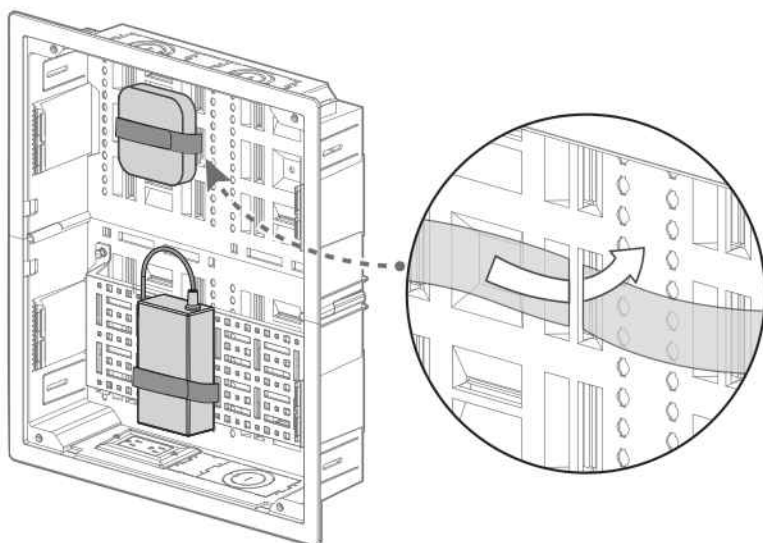

Piezas suministradas y artículos de ferretería para Paso 5



Cubrir
06 x 2

PASO 5 Instalación de la Caja Cubrir

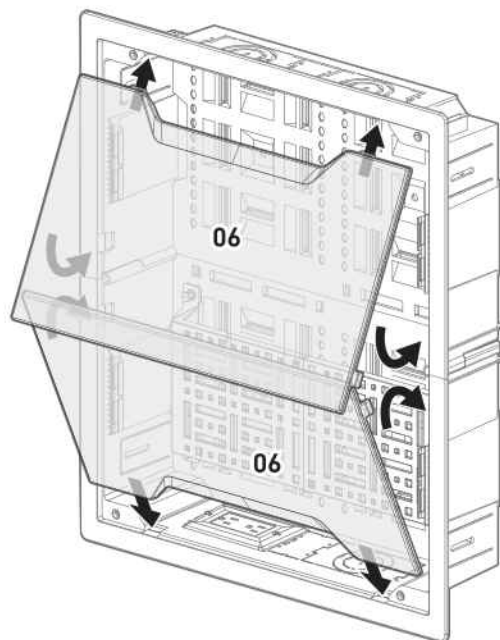

ERGOAV™

At ErgoAV, our goal is to provide the high-quality audio video solutions and product support that you need. If you have any questions, concerns, or feedback, please let us know!

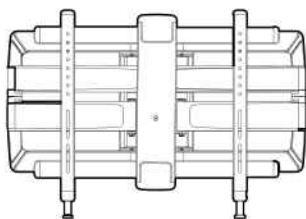

TV Mounts

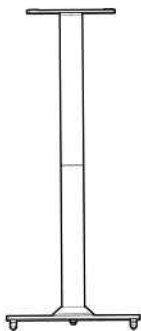

Speaker Stands

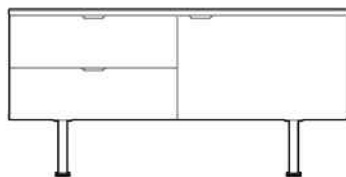

A/V Furniture

 ErgoAV

 9501 Louisiana Ave N, #200, Brooklyn Park, MN 55445

 (877) 419-7832 Mon-Fri 8am - 8pm (CST)

 support@ergoav.com

 www.ergoav.com

860-03551-00 Rev00